

NOTICE!!

These documents have been scanned!

Do not place un-scanned documents beneath this notice!

Do not remove this notice from this file!

GPO Jacket No. 560-102
Print Order 61540
Rise Business Services, LLC
Job=AZ15 5/1/2019



Box Number= AZ15013



Claim Begin-End: AMC440223-AMC440228

1 Initial Receipt





AZ15013-7

AMC440098-AMC440515

United States Department of the Interior
Bureau of Land Management
 DIV OF LANDS, MINRLS & ENERGY
 ONE N CENTRAL AVE
 PHOENIX, AZ 85004 -4427
 Phone: 602-417-9200

Receipt

No: 3699436

Transaction #: 3804177	
Date of Transaction: 11/16/2016	
CUSTOMER:	
GRE INC 2091 E MURRAY HOLLADAY RD STE 22E SALT LAKE CITY,UT 84117-5017 US	 BY: 

LINE #	QTY	DESCRIPTION	REMARKS	UNIT PRICE	TOTAL
1	6.00	LOCATABLE MINERALS / MINING CLAIMS-NEW,UNADJUD, ONE OR MORE AUTH NOS / NEW MINING CLAIM PROCESSING FEE CASES: AMC440223/\$20.00, AMC440224/\$20.00, AMC440225/\$20.00, AMC440226/\$20.00, AMC440227/\$20.00, AMC440228/\$20.00		- n/a -	120.00
2	6.00	LOCATABLE MINERALS / MINING CLAIMS-NEW,UNADJUD, ONE OR MORE AUTH NOS / NEW MINING CLAIMS MAINTENANCE FEE CASES: AMC440223/\$155.00, AMC440224/\$155.00, AMC440225/\$155.00, AMC440226/\$155.00, AMC440227/\$155.00, AMC440228/\$155.00		- n/a -	930.00
3	6.00	LOCATABLE MINERALS / MINING CLAIMS-NEW,UNADJUD, ONE OR MORE AUTH NOS / NEW MINING CLAIMS LOCATION FEE CASES: AMC440223/\$37.00, AMC440224/\$37.00, AMC440225/\$37.00, AMC440226/\$37.00, AMC440227/\$37.00, AMC440228/\$37.00		- n/a -	222.00
TOTAL:					\$1,272.00

PAYMENT INFORMATION			
1	AMOUNT:	1272.00	POSTMARKED: N/A
	TYPE:	CHECK	RECEIVED: 11/15/2016
	CHECK NO:	003478	
	NAME:	GRE INC 2091 E MURRAY HOLLADAY RD STE 22E	

	SALT LAKE CITY UT 84117-5017 US
--	---------------------------------

REMARKS

This receipt was generated by the automated BLM Collections and Billing System and is a paper representation of a portion of the official electronic record contained therein.

NOTICE!!

These documents have been scanned!

Do not place un-scanned documents beneath this notice!

Do not remove this notice from this file!

GPO Jacket No. 560-102
Print Order 61540
Rise Business Services, LLC
Job=AZ15 5/1/2019

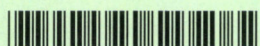

Box Number= AZ15013



Claim Begin-End: AMC440223-AMC440228

2 Correspondence



AZ15013-7

AMC440098-AMC440515



United States Department of the Interior



BUREAU OF LAND MANAGEMENT
Arizona State Office
One North Central Avenue, Suite 800
Phoenix, Arizona 85004-4427
www.blm.gov/az/

FEB 13 2019

In Reply Refer To:
3800 (AZ-9200) RM
AMC440223

CERTIFIED MAIL - RETURN RECEIPT REQUESTED 9214 8901 9403 8378 7192 61

NOTICE

RICK PANIAGUA : This Notice Affects Those Claims
PO BOX 301 : Shown in the Block Below.
SAWYER, MI 49125-0301 :

AMC440224, AMC440227
DARDANELLES, ROSE

Additional Processing Fees Required

The Arizona State Office, Bureau of Land Management, received your Affidavit of Labor or Notice of Intent to Hold for the 2018 assessment year.

Due to a processing fee increase effective October 1, 2018, we did not receive sufficient fees with your document. The fee increased from \$10 per mining claim to \$15 per mining claim.

Therefore, you are required to submit an additional payment in the amount of \$5.00 per claim, within 30 days of receipt of this notice or your claim(s) will be declared forfeited.

Please include your Arizona Mining Claim (AMC) serial number(s) and claim name(s) when submitting the additional fees. If additional information is required, please contact RéAnn Myers at 602-417-9413.

Lucas Lucero
Deputy State Director
Lands, Minerals and Energy Division



Date Produced: 03/04/2019

ConnectSuite Inc.:

The following is the delivery information for Certified Mail™/RRE item number 9214 8901 9403 8378 7192 61. Our records indicate that this item was delivered on 02/28/2019 at 12:56 p.m. in SAWYER, MI 49125. The scanned image of the recipient information is provided below.

Signature of Recipient :

A handwritten signature in black ink, appearing to read "Paul M. Sawyer".

Address of Recipient :

A handwritten address in black ink that reads "Po Box 301".

Thank you for selecting the Postal Service for your mailing needs. If you require additional assistance, please contact your local post office or Postal Service representative.

Sincerely,
United States Postal Service

The customer reference number shown below is not validated or endorsed by the United States Postal Service. It is solely for customer use.

Customer Reference Number: C1217506.6967742

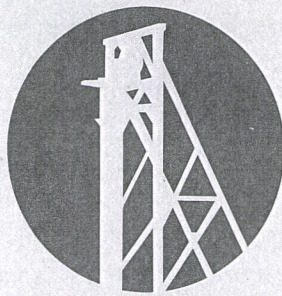

GOLD RUSH EXPEDITIONS

437130
437132
437935
438326
11/15/2017

439949

440223

440245

440367

440526

440552

441034

441153

442189

443322

PHOENIX, ARIZONA

2017 NOV 20 P 2:31

RECEIVED
BLM AZ STATE OFFICE

GRE, Inc.
331 S. Rio Grande Street
Suite #201
SLC, UT 84101

Arizona BLM

Re: Change of Address

Dear Arizona BLM,

Please make a not that GRE Inc. Office has moved. Please change our address to the following

GRE, Inc.
331 S. Rio Grande Street
Suite #201
SLC, UT 84101

443510

444671

We have the following claims

- FESTERLING, AMC437130
- HILLTOP, AMC437134
- MORNING STAR, AMC437935
- BLACK GOLD, AMC438326
- FLAG, AMC439949
- C.O.D., AMC440223
- ARIZONA RAND, AMC440245
- RAWHIDE, AMC440367
- RAWHIDE EXTENSION, AMC440368
- GIBSON EXTENSION, AMC440532
- HOSEY, AMC440534
- JIMMIE, AMC440536
- LUCKY BOY, AMC440538
- MICA GIANT, AMC440539
- NEW STANDARD, AMC440540
- NEW STANDARD EXT, AMC440541

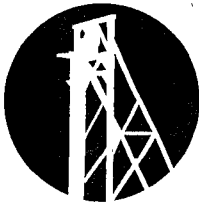

GOLD RUSH

GRE Inc.
331 S. RIO GRANDE ST
SUITE #201
SLC, UT 84101

Arizona BLM
Attn: Cashier
One N. Central Ave., Ste. 800
Phoenix, AZ 85004



US POSTAGE
FIRST CLASS
062900903198
FROM BMTV
88 Cents

PHOENIX, ARIZONA

2017 NOV 20 P 2:31

RECEIVED
BLM STATE OFFICE

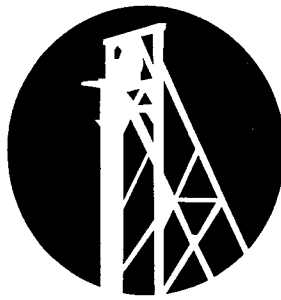

GOLD RUSH EXPEDITIONS

ST LOUIS, AMC440544
TELLURIDE CHIEF, AMC440545
TWILIGHT ZONE, AMC440547
VERDE COMBINATION, AMC440548
YELLOW BREAST, AMC440549
GOLDEN BELT, AMC440552
GOLDEN TURKEY, AMC440553
BULL CANYON, AMC441034
APEX, AMC441153
GREEN STREAK, AMC441154
TALLEY, AMC441155
BLACK MOUNTAIN, AMC442189
CARMELITA, AMC442190
FOUR PEAKS, AMC442191
FOUR PEAKS EXT, AMC442192
GREAT BEAR, AMC442193
JASPER, AMC442194
AGATE AND PALM, AMC443322
ALASKAN, AMC443323
ARRASTRA, AMC443324
ARRASTRA, AMC443325
COPPER QUEEN, AMC443326
PLAMOSA, AMC443330
TEXAS QUEEN, AMC443331
AMBASSADOR, AMC443510
RADIO, AMC443511
UNITED STATES, AMC443512
CARMELITA 1, AMC444671
CARMELITA 2, AMC444672

Thank you for your time and efforts.

Sincerely,

GRE Accounting
385-218-2138
accounting@goldrushexpeditions.com
www.goldrushexpeditions.com

RECEIVED
BLM AZ STATE OFFICE
2017 NOV 20 P 2:31
PHOENIX, ARIZONA

NOTICE!!

These documents have been scanned!

Do not place un-scanned documents beneath this notice!

Do not remove this notice from this file!

GPO Jacket No. 560-102
Print Order 61540
Rise Business Services, LLC
Job=AZ15 5/1/2019



Box Number= AZ15013



Claim Begin-End: AMC440223-AMC440228

3 Transfers



AZ15013-7

AMC440098-AMC440515

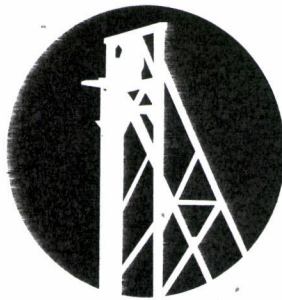

GOLD RUSH
EXPEDITIONS

440223

1/18/2017

GRE, Inc.
2091 E. Murray Holladay Road
Suite #22E
SLC, UT 84117

RUSH

ARIZONA BLM

Re: ^{TWO} ~~ONE~~ QUIT CLAIM DEED(s)

Dear ARIZONA BLM Cashier,

Please find enclosed ^{TWO} ~~ONE~~ QUICK CLAIM DEED (s) for filing. I understand there is a fee for recording each of these documents. I have enclosed a check for the fees. Please apply the appropriate amount owed for filing fees and send a receipt with the recorded documents.

I have also enclosed a postage paid envelope for the document(s) to be returned.

Thank you for your time and efforts.

Sincerely,

GRE Accounting
385-218-2138
accounting@goldrushexpeditions.com
www.goldrushexpeditions.com

RECEIVED
JAN 23 P 3:01
BLM, ARIZONA

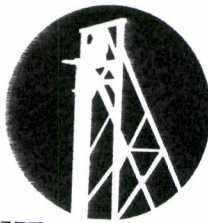

GOLD RUSH
EXPEDITIONS

AMC 440223

When Recorded Mail To:

GRE Inc
2091 E Murray Holladay Road
Suite 22E
SLC, UT 84117

Quit Claim Deed

Quit Claim Deed Exempt Per ARS 11-1134 A6

THE GRANTOR(S): GRE, Inc., of the City of Salt Lake, County of Salt Lake, State of Utah, 84117

For and in consideration \$1,750.00 (One thousand seven hundred fifty Dollars and Zero Cents), do CONVEY and QUIT CLAIM to:

THE GRANTEE(S):

- Steven B. Hull & Sandra L. R. Hull of 7460 Winona Ct., in the city Westminster, county of Adams, state of Colorado 80030,

In the form of Sole Ownership, all interest in the following described Mining Claim Property(s) situated in the County of Mohave, in the State of Arizona, to wit:

- Peacock, AMC #440225 Located in sec. 8, Township 23N, Range 14W

Hereby releasing and waiving all rights under and by virtue of the Mining and Location laws of the State of Arizona.

Dated this 19th day of January, 2017

Signature(s) of Grantor(s):

[Signature]
CRYSTAL SUTTON GRE, Inc. Representative

RECEIVED
PLAT REGISTERED
2017 JAN 30 PM 3:10
PHOENIX, ARIZONA

Name & Address of Preparer: CRYSTAL SUTTON, an Agent for GRE, Inc. -
2091 E. Murray Holladay Road #22E- SLC, Utah 84117

SIGNED *[Signature]*
Signature of Claim owner's agent CRYSTAL SUTTON

BY CRYSTAL SUTTON
Printed name of Claim owner's agent
STATE OF UTAH
COUNTY OF SALT LAKE

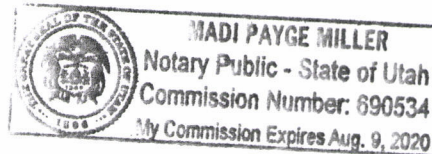

On the 19th day of January, 2017, CRYSTAL SUTTON did personally appear before me, the undersigned notary public in and for the County of Salt Lake, in said State of Utah, Who acknowledged to me that he/she signed it freely and voluntarily for the purposes therein mentioned?

[Signature]
Notary Public of Salt Lake County, Utah

My commission expires on: August 9th 2020

ENTERED FEB 23 2017

[Signature]

United States Department of the Interior
Bureau of Land Management
 DIV OF LANDS, MINRLS & ENERGY
 ONE N CENTRAL AVE
 PHOENIX, AZ 85004 -4427
 Phone: 602-417-9200

Receipt

No: 3752157

Transaction #: 3858003	
Date of Transaction: 01/31/2017	
CUSTOMER:	
GRE INC 2091 E MURRAY HOLLADAY RD STE 22E SALT LAKE CITY, UT 84117-5017 US	

LINE #	QTY	DESCRIPTION	REMARKS	UNIT PRICE	TOTAL
1	1.00	LOCATABLE MINERALS / MINING CLAIMS- NOT NEW-UNADJUD, ONE AUTH NO. ONLY / MINING CLAIM MONEY RECEIVED CASES: AMC440242/\$30.00	QCD - 3	- n/a -	30.00
TOTAL:					\$30.00

PAYMENT INFORMATION					
1	AMOUNT:	30.00	POSTMARKED:	N/A	
	TYPE:	CHECK	RECEIVED:	01/30/2017	
	CHECK NO:	003915			
	NAME:	GRE INC 2091 E MURRAY HOLLADAY RD STE 22E SALT LAKE CITY UT 84117-5017 US			

REMARKS

This receipt was generated by the automated BLM Collections and Billing System and is a paper representation of a portion of the official electronic record contained therein.

*Receipt used to process transfers of:
 AMC 440242 (\$10)
 AMC 440225 (\$20)*

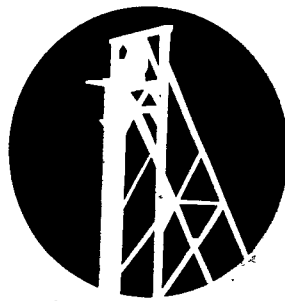

GOLD RUSH
EXPEDITIONS

1/24/2017

GRE, Inc.
2091 E. Murray Holladay Road
Suite #22E
SLC, UT 84117

RUSH

ARIZONA BLM

Re: TWO QUIT CLAIM DEED(s)

Dear ARIZONA BLM Cashier,

Please find enclosed TWO QUIT CLAIM DEED (s) for filing. I understand there is a fee for recording each of these documents. I have enclosed a check for the fees. Please apply the appropriate amount owed for filing fees and send a receipt with the recorded documents.

I have also enclosed a postage paid envelope for the document(s) to be returned.

Thank you for your time and efforts.

Sincerely,

GRE Accounting
385-218-2138
accounting@goldrushexpeditions.com
www.goldrushexpeditions.com

RECEIVED
BLM AZ STATE OFFICE
2017 JAN 30 P 3:10
PHOENIX, ARIZONA

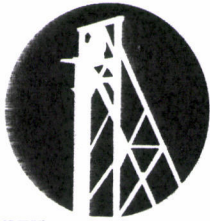

GOLD RUSH EXPEDITIONS

AMC 440223

When Recorded Mail To:
GRE Inc
2091 E Murray Holladay Road
Suite 22E
SLC, UT 84117

Quit Claim Deed

Quit Claim Deed Exempt Per ARS 11-1134 A6

THE GRANTOR(S): GRE, Inc., of the City of Salt Lake, County of Salt Lake, State of Utah, 84117

For and in consideration \$2,176.00 (Two thousand one hundred seventy six Dollars and Zero Cents), do CONVEY and QUIT CLAIM to:

THE GRANTEE(S):

- Jeri Victoria Forga of 205 Castle Drive, in the city Atawater, county of Merced, state of CA 95301,

In the form of Sole Ownership, all interest in the following described Mining Claim Property(s) situated in the County of Mohave, in the State of Arizona, to wit:

- Inauguration, AMC #440226 Located in sec. 12, Township 22N, Range 18W

Hereby releasing and waiving all rights under and by virtue of the Mining and Location laws of the State of Arizona.

Dated this 12th day of January, 2017

Signature(s) of Grantor(s):

CRYSTAL SUTTON GRE, Inc. Representative

RECEIVED
JAN 23 P 3:00
MOHAVE, ARIZONA

Name & Address of Preparer: CRYSTAL SUTTON, an Agent for GRE, Inc. -
2091 E. Murray Holladay Road #22E- SLC, Utah 84117

SIGNED
Signature of Claim owner's agent CRYSTAL SUTTON

BY CRYSTAL SUTTON
Printed name of Claim owner's agent
STATE OF UTAH
COUNTY OF SALT LAKE

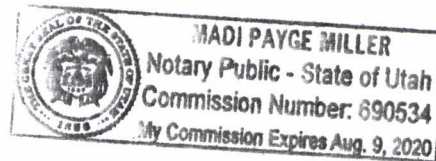

On the 12th day of January, 2017, CRYSTAL SUTTON did personally appear before me, the Undersigned notary public in and for the County of Salt Lake, in said State of Utah, Who acknowledged to me that he/she signed it freely and voluntarily for the purposes therein mentioned?

Notary Public of Salt Lake County, Utah

My commission expires on: August 9th, 2020

ENTERED FEB 23 2017

United States Department of the Interior
Bureau of Land Management
 DIV OF LANDS, MINRLS & ENERGY
 ONE N CENTRAL AVE
 PHOENIX, AZ 85004 -4427
 Phone: 602-417-9200

Receipt

No: 3747789

Transaction #: 3853545	
Date of Transaction: 01/24/2017	
CUSTOMER:	
GRE INC 2091 E MURRAY HOLLADAY RD STE 22E SALT LAKE CITY,UT 84117-5017 US	

LINE #	QTY	DESCRIPTION	REMARKS	UNIT PRICE	TOTAL
1	1.00	LOCATABLE MINERALS / MINING CLAIMS- NOT NEW-UNADJUD,ONE AUTH NO. ONLY / MINING CLAIM MONEY RECEIVED CASES: AMC440226/\$10.00	QCD - 1	- n/a -	10.00
TOTAL:					\$10.00

PAYMENT INFORMATION			
1	AMOUNT:	10.00	POSTMARKED: 01/19/2017
	TYPE:	CHECK	RECEIVED: 01/23/2017
	CHECK NO:	003933	
	NAME:	GRE INC 2091 E MURRAY HOLLADAY RD STE 22E SALT LAKE CITY UT 84117-5017 US	

REMARKS

This receipt was generated by the automated BLM Collections and Billing System and is a paper representation of a portion of the official electronic record contained therein.

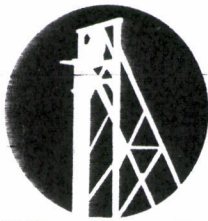

GOLD RUSH EXPEDITIONS

Am 440223

When Recorded Mail To:
GRE Inc
2091 E Murray Holladay Road
Suite 22E
SLC, UT 84117

Quit Claim Deed

Quit Claim Deed Exempt Per ARS 11-1134 A6

THE GRANTOR(S): GRE, Inc., of the City of Salt Lake, County of Salt Lake, State of Utah, 84117

For and in consideration \$3,251.00 (Three thousand two hundred fifty one Dollars and Zero Cents), do CONVEY and QUIT CLAIM to:

THE GRANTEE(S):

- Kenneth Tallmage of 7168 River Road, in the city Lemington, county of Essex, state of Vermont 05903,

In the form of Sole Ownership, all interest in the following described Mining Claim Property(s) situated in the County of Mohave, in the State of Arizona, to wit:

- South Pilgrim, AMC #440228 Located in sec. 13, Township 23N, Range 20W

Hereby releasing and waiving all rights under and by virtue of the Mining and Location laws of the State of Arizona.

Dated this 5 day of January, 2017

Signature(s) of Grantor(s):

CRYSTAL SUTTON GRE, Inc. Representative

Name & Address of Preparer: **CRYSTAL SUTTON, an Agent for GRE, Inc. -**
2091 E. Murray Holladay Road #22E- SLC, Utah 84117

SIGNED
Signature of Claim owner's agent CRYSTAL SUTTON

BY CRYSTAL SUTTON
Printed name of Claim owner's agent
STATE OF UTAH
COUNTY OF SALT LAKE

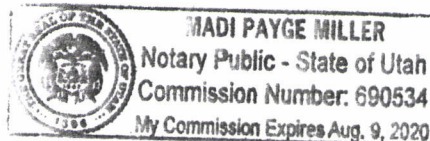

On the 5th day of January, 2017, CRYSTAL SUTTON did personally appear before me, the Undersigned notary public in and for the County of Salt Lake, in said State of Utah, Who acknowledged to me that he/she signed it freely and voluntarily for the purposes therein mentioned?

Notary Public of Salt Lake County, Utah

My commission expires on: August 9th, 2020

ENTERED INTO COMPUTER

3/10/17

United States Department of the Interior
Bureau of Land Management
 DIV OF LANDS, MINRLS & ENERGY
 ONE N CENTRAL AVE
 PHOENIX, AZ 85004 -4427
 Phone: 602-417-9200

Receipt

No: 3747779

Transaction #: 3853533	
Date of Transaction: 01/24/2017	
CUSTOMER:	
GRE INC 2091 E MURRAY HOLLADAY RD SUITE 22E SALT LAKE CITY,UT 84117-5017 US	

LINE #	QTY	DESCRIPTION	REMARKS	UNIT PRICE	TOTAL
1	1.00	LOCATABLE MINERALS / MINING CLAIMS- NOT NEW-UNADJUD,ONE AUTH NO. ONLY / MINING CLAIM MONEY RECEIVED CASES: AMC440228/\$10.00	QCD - 1	- n/a -	10.00
TOTAL:					\$10.00

PAYMENT INFORMATION					
1	AMOUNT:	10.00	POSTMARKED:	01/19/2017	
	TYPE:	CHECK	RECEIVED:	01/23/2017	
	CHECK NO:	003930			
	NAME:	GRE INC 2091 E MURRAY HOLLADAY RD SUITE 22E SALT LAKE CITY UT 84117-5017 US			

REMARKS

This receipt was generated by the automated BLM Collections and Billing System and is a paper representation of a portion of the official electronic record contained therein.

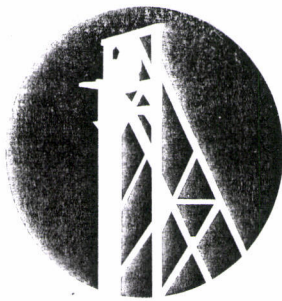

GOLD RUSH
EXPEDITIONS

440223

1/6/2017

GRE, Inc.
2091 E. Murray Holladay Road
Suite #22E
SLC, UT 84117

ARIZONA BLM

Re: ONE QUIT CLAIM DEED ONE CERTIFICATE OF LOCATION(s)

Dear ARIZONA BLM Cashier,

Please find enclosed ONE QUIT CLAIM DEED ONE CERTIFICATE OF LOCATION (s) for filing. I understand there is a fee for recording each of these documents. I have enclosed a check for the fees. Please apply the appropriate amount owed for filing fees and send a receipt with the recorded documents.

I have also enclosed a postage paid envelope for the document(s) to be returned.

Thank you for your time and efforts.

Sincerely,

GRE Accounting
385-218-2138
accounting@goldrushexpeditions.com
www.goldrushexpeditions.com

RUSH

RECEIVED
2017 JAN 10 PM 2:40
MURRAY, ARIZONA

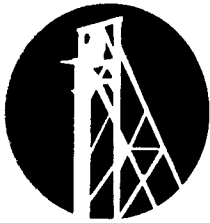

GOLD RUSH EXPEDITIONS

When Recorded Mail To:
GRE Inc
2091 E Murray Holladay Road
Suite 22E
SLC, UT 84117

Quit Claim Deed

Quit Claim Deed Exempt Per ARS 11-1134 A6

THE GRANTOR(S): GRE, Inc., of the City of Salt Lake, County of Salt Lake, State of Utah, 84117

For and in consideration \$1,925.00 (One thousand nine hundred twenty five Dollars and Zero Cents), do CONVEY and QUIT CLAIM to:

THE GRANTEE(S):

- Rick Paniagua of PO BOX 301, in the city Sawyer, county of Berrien, state of Michigan 49125,

In the form of Sole Ownership, all interest in the following described Mining Claim Property(s) situated in the County of Mohave, in the State of Arizona, to wit:

- Rose, AMC #440227 Located in sec. 10, Township 19N, Range 20W

Hereby releasing and waiving all rights under and by virtue of the Mining and Location laws of the State of Arizona.

Dated this 30 day of December, 2016

Signature(s) of Grantor(s):

CRYSTAL SUTTON GRE, Inc. Representative

Name & Address of Preparer: CRYSTAL SUTTON, an Agent for GRE, Inc. -
2091 E. Murray Holladay Road #22E- SLC, Utah 84117

SIGNED
Signature of Claim owner's agent CRYSTAL SUTTON

BY CRYSTAL SUTTON
Printed name of Claim owner's agent
STATE OF UTAH
COUNTY OF SALT LAKE

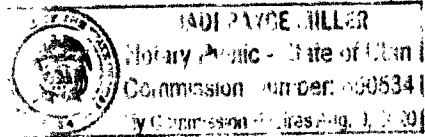

On the 30 day of December, 2016, CRYSTAL SUTTON did personally appear before me, the Undersigned notary public in and for the County of Salt Lake, in said State of Utah, Who acknowledged to me that he/she signed it freely and voluntarily for the purposes therein mentioned?

Notary Public of Salt Lake County, Utah

My commission expires on: August 9, 2020

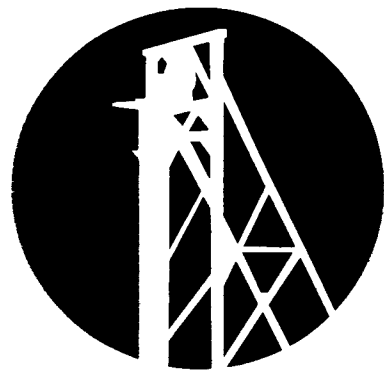

GOLD RUSH

EXPEDITIONS

2091 E. MURRAY HOLLADAY RD, STE. 22E

SALT LAKE CITY, UTAH 84117



7016 1370 0001 1714 5369



94889 10000000
POSTAGE
PAID
BY ADDRESSEE
PERMIT NO. 117
SALT LAKE CITY, UT

Arizona BLM
Attn: Cashier
One N. Central Ave., Ste. 800
Phoenix, AZ 85004

PHOENIX, ARIZONA
2017 JAN 10 P 2:50

-RECEIVED

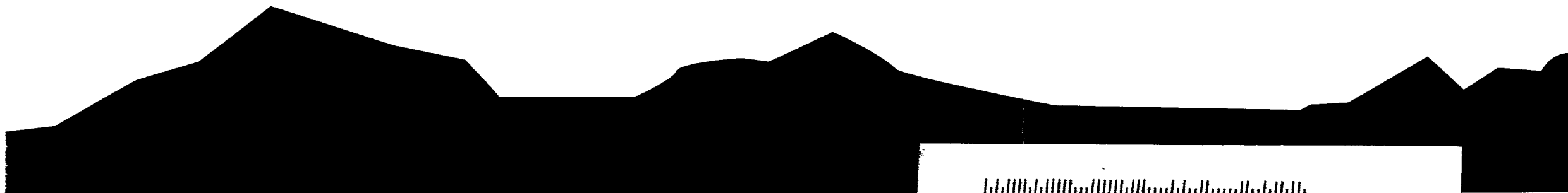

United States Department of the Interior
Bureau of Land Management
 DIV OF LANDS, MINRLS & ENERGY
 ONE N CENTRAL AVE
 PHOENIX, AZ 85004 -4427
 Phone: 602-417-9200

Receipt

No: 3740945

Transaction #: 3846531	
Date of Transaction: 01/11/2017	
CUSTOMER:	
GRE INC 2091 E MURRAY HOLLADAY RD SUITE 22E SALT LAKE CITY,UT 84117-5017 US	

LINE #	QTY	DESCRIPTION	REMARKS	UNIT PRICE	TOTAL
1	1.00	LOCATABLE MINERALS / MINING CLAIMS- NOT NEW-UNADJUD, ONE AUTH NO. ONLY / MINING CLAIM MONEY RECEIVED CASES: AMC440227/\$10.00	QCD (1)	- n/a -	10.00

Transaction #: 3846533	
Date of Transaction: 01/11/2017	
CUSTOMER:	
GRE INC 2091 E MURRAY HOLLADAY RD SUITE 22E SALT LAKE CITY,UT 84117-5017 US	

LINE #	QTY	DESCRIPTION	REMARKS	UNIT PRICE	TOTAL
1	1.00	LOCATABLE MINERALS / MINING CLAIMS- NEW, UNADJUD, ONE OR MORE AUTH NOS / NEW MINING CLAIM PROCESSING FEE CASES: AMC441034/\$20.00		- n/a -	20.00
2	1.00	LOCATABLE MINERALS / MINING CLAIMS- NEW, UNADJUD, ONE OR MORE AUTH NOS / NEW MINING CLAIMS LOCATION FEE CASES: AMC441034/\$37.00		- n/a -	37.00
3	1.00	LOCATABLE MINERALS / MINING CLAIMS- NEW, UNADJUD, ONE OR MORE AUTH NOS / NEW MINING CLAIMS MAINTENANCE FEE		- n/a -	155.00

CASES: AMC441034/\$155.00			
TOTAL:			\$222.00

PAYMENT INFORMATION				
1	AMOUNT:	222.00	POSTMARKED:	N/A
	TYPE:	CHECK	RECEIVED:	01/10/2017
	CHECK NO:	003905		
	NAME:	GRE INC 2091 E MURRAY HOLLADAY RD SUITE 22E SALT LAKE CITY UT 84117-5017 US		

REMARKS

This receipt was generated by the automated BLM Collections and Billing System and is a paper representation of a portion of the official electronic record contained therein.

ENTERED
 JAN 13 2017
 BY: *[Signature]*

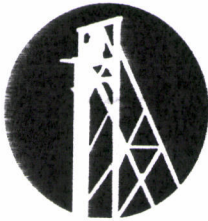

GOLD RUSH EXPEDITIONS

440223

RECEIVED
BLM AZ STAFF OFFICE
2017 JAN -3 P 2:52
PHOENIX, ARIZONA

When Recorded Mail To:
GRE Inc
2091 E Murray Holladay Road
Suite 22E
SLC, UT 84117

Quit Claim Deed

Quit Claim Deed Exempt Per ARS 11-1134 A6

THE GRANTOR(S): GRE, Inc., of the City of Salt Lake, County of Salt Lake, State of Utah, 84117

For and in consideration \$3,276.00 (Three thousand two hundred seventy six Dollars and zero Cents), do CONVEY and QUIT CLAIM to:

THE GRANTEE(S):

- Richard Paniagua of PO BOX 301, in the city Sawyer, county of Berrien, state of MI 49125,

In the form of Sole Ownership, all interest in the following described Mining Claim Property(s) situated in the County of Mohave, in the State of Arizona, to wit:

- Dardanelles, AMC #440224 Located in sec. 34, Township 24N, Range 18W

Hereby releasing and waiving all rights under and by virtue of the Mining and Location laws of the State of Arizona.

Dated this 21st day of December, 2016

Signature(s) of Grantor(s):

[Signature]
CRYSTAL SUTTON GRE, Inc. Representative

Name & Address of Preparer: CRYSTAL SUTTON, an Agent for GRE, Inc. -
2091 E. Murray Holladay Road #22E- SLC, Utah 84117

SIGNED [Signature]
Signature of Claim owner's agent CRYSTAL SUTTON

BY CRYSTAL SUTTON
Printed name of Claim owner's agent
STATE OF UTAH
COUNTY OF SALT LAKE

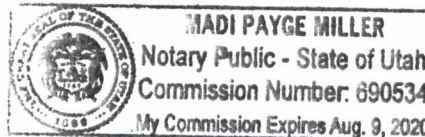

On the 21st day of December, 2016, CRYSTAL SUTTON did personally appear before me, the Undersigned notary public in and for the County of Salt Lake, in said State of Utah, Who acknowledged to me that he/she signed it freely and voluntarily for the purposes therein mentioned?

[Signature]
Notary Public of Salt Lake County, Utah

My commission expires on: August 9TH, 2020

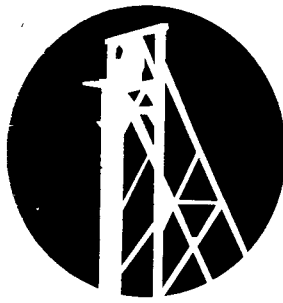

GOLD RUSH
EXPEDITIONS

12/26/2016

GRE, Inc.
2091 E. Murray Holladay Road
Suite #22E
SLC, UT 84117

ARIZONA BLM

Re: ONE QUIT CLAIM DEED(s)

RUSH

Dear ARIZONA BLM Cashier,

Please find enclosed ONE QUIT CLAIM DEED (s) for filing. I understand there is a fee for recording each of these documents. I have enclosed a check for the fees. Please apply the appropriate amount owed for filing fees and send a receipt with the recorded documents.

I have also enclosed a postage paid envelope for the document(s) to be returned.

Thank you for your time and efforts.

Sincerely,

GRE Accounting
385-218-2138
accounting@goldrushexpeditions.com
www.goldrushexpeditions.com

BLM RECEIVED
2017 JAN -3 P 2:51
PHOENIX, ARIZONA

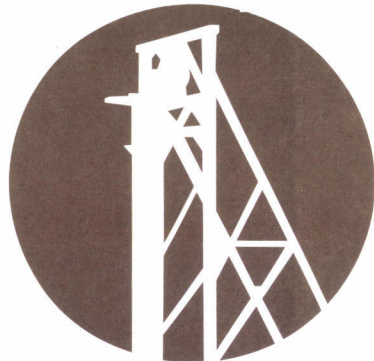

GOLD RUSH

EXPEDITIONS

2091 E. MURRAY HOLLADAY RD, STE. 22E

SALT LAKE CITY, UTAH 84117

SALT LAKE UT 841

TUE 27 DEC 2016 PM



\$1.150 US POSTAGE
FIRST CLASS
06730009931348
FROM 84117

Arizona BLM
Attn: Cashier
One N. Central Ave., Ste. 800
Phoenix, AZ 85004

RECEIVED
BLM ARIZONA OFFICE

2017 JAN -3 P 2:51

PHOENIX, ARIZONA



United States Department of the Interior
Bureau of Land Management
 DIV OF LANDS, MINRLS & ENERGY
 ONE N CENTRAL AVE
 PHOENIX, AZ 85004 -4427
 Phone: 602-417-9200

Receipt

No: 3735905

Transaction #: 3841338	
Date of Transaction: 01/03/2017	
CUSTOMER:	
GRE INC 2091 E MURRAY HOLLADAY RD SUITE 22E SALT LAKE CITY,UT 84117-5017 US	

LINE #	QTY	DESCRIPTION	REMARKS	UNIT PRICE	TOTAL
1	1.00	LOCATABLE MINERALS / MINING CLAIMS- NOT NEW-UNADJUD,ONE AUTH NO. ONLY / MINING CLAIM MONEY RECEIVED CASES: AMC440224/\$10.00	TRF/1	- n/a -	10.00
TOTAL:					\$10.00

PAYMENT INFORMATION					
1	AMOUNT:	10.00	POSTMARKED:	12/27/2016	
	TYPE:	CHECK	RECEIVED:	01/03/2017	
	CHECK NO:	003879			
	NAME:	GRE INC 2091 E MURRAY HOLLADAY RD SUITE 22E SALT LAKE CITY UT 84117-5017 US			

REMARKS

This receipt was generated by the automated BLM Collections and Billing System and is a paper representation of a portion of the official electronic record contained therein.

ENTERED
 JAN - 9 2017
 BY: 

NOTICE!!

These documents have been scanned!

Do not place un-scanned documents beneath this notice!

Do not remove this notice from this file!

GPO Jacket No. 560-102
Print Order 61540
Rise Business Services, LLC
Job=AZ15 5/1/2019



Box Number= AZ15013



Claim Begin-End: AMC440223-AMC440228

4 Annual Filings



AZ15013-7

AMC440098-AMC440515

301

440223

MAINTENANCE FEE WAIVER CERTIFICATION

FORM APPROVED
OMB NO. 1004-0114
Expires: January 31, 2020

SEE INSTRUCTIONS ON PAGE 2

1. This small miner waiver is filed for the assessment year beginning on September 1, 2019 and ending on September 1, 2020.
2. The undersigned and all related parties owned ten or fewer mining claims, mill, or tunnel sites located and maintained on Federal lands in the United States of America on September 1, 2019.
3. The undersigned have performed the assessment work required by law for each mining claim listed prior to filing this waiver and understand that by filing this form, the undersigned must file an affidavit of assessment work with the Bureau of Land Management (BLM) by the December 30th following the filing of this waiver.
4. The undersigned understand that if the assessment work obligation has not yet come due under 30 U.S.C. 28 (for those claims in their first assessment year only), a notice of intent to hold reciting this condition must be recorded by the December 30th following the filing of this waiver.
5. The undersigned understand that mill and tunnel sites may also be listed on this waiver and be waived from payment of the maintenance fee, and that a notice of intent to hold for these sites is required to be filed with the BLM by the December 30th following the filing of this waiver.
6. The undersigned understand and acknowledge that pursuant to 43 U.S.C. 1212 and 18 U.S.C. 1001, the filing or recording of a false, fictitious, or fraudulent document with the BLM may result in a fine of up to \$250,000, a prison term not to exceed five years, or both.
7. The mining claims, mill or tunnel sites for which this waiver from payment of the maintenance fees is requested are:

CLAIM OR SITE NAME	BLM RECORDATION SERIAL NUMBER
1. South Pilgrim ✓	Amc 440228
2.	
3.	
4.	
5.	
6.	
7.	
8.	
9.	
10.	

The owner(s) (claimants) of the above mining claims and sites are:

Kenneth Tallmage
(Owner's Name - Please Print)
3969 N. Elgin rd
(Owner's Mailing Address)

Kenneth Tallmage
(Owner's Signature)
Golden Valley AZ. 86413
(City) (State) (Zip Code)

(Owner's Name - Please Print)

(Owner's Signature)

(Owner's Mailing Address)

(City)

(State)

(Zip Code)

(Owner's Name - Please Print)

(Owner's Signature)

(Owner's Mailing Address)

(City)

(State)

(Zip Code)

(Owner's Name - Please Print)

(Owner's Signature)

(Owner's Mailing Address)

(City)

(State)

(Zip Code)

(Continued on page 2)

PHOENIX, ARIZONA
2019 AUG 22 P 1:23

RECEIVED
BLM AT STATE OFFICE

ENTERED
SEP 18 2019

BY: [Signature]

nw
[Signature]

(Owner's Name - Please Print)	(Owner's Signature)		
(Owner's Mailing Address)	(City)	(State)	(Zip Code)
(Owner's Name - Please Print)	(Owner's Signature)		
(Owner's Mailing Address)	(City)	(State)	(Zip Code)
(Owner's Name - Please Print)	(Owner's Signature)		
(Owner's Mailing Address)	(City)	(State)	(Zip Code)
(Owner's Name - Please Print)	(Owner's Signature)		
(Owner's Mailing Address)	(City)	(State)	(Zip Code)

18 U.S.C. 1001 and 43 U.S.C. 1212 make it a crime for any person knowingly and willfully to make to any department or agency of the United States any false, fictitious or fraudulent statements or representations as to any matter within its jurisdiction.

INSTRUCTIONS

1. This certification is made under the provisions of 43 U.S.C. § 1744 and 30 U.S.C. §28-28k and the regulations thereunder (43 CFR Part 3830).
2. The claimant(s) must fill in the dates in paragraph 1 for the beginning and ending of the assessment year for which this waiver is sought.
3. The claimant(s) must fill in the date in paragraph 2 for the beginning of the assessment year for which this waiver is sought.
4. All claim and site names and BLM serial numbers must be listed for the mining claims, mill sites, and tunnel sites for which the waiver is sought.
5. All owners of the mining claims, mill sites, and tunnel sites and their addresses must be given.
6. This waiver form must be signed by all the claimants or their designated agent, in original form. If an agent is designated, a notarized designation of agent, signed by all of the claimants with proper address given, must be submitted with this waiver.
7. This form must be filed no later than September 1st for the upcoming assessment year in the BLM State Office where the mining claims or sites are recorded, or the waiver cannot be granted by the BLM. (Example: To obtain a waiver for the assessment year 2012, which begins on September 1, 2011, you must qualify for and file for a waiver no later than September 1, 2011, in the proper BLM State Office.)
8. For all mining claims which require assessment work, you must record an affidavit of labor on or before the December 30th immediately following the filing of this waiver. For all other mining claims or sites waived, you must record a notice of intent to hold on or before the December 30th immediately following the filing of this waiver.
9. Mill and tunnel sites may also be listed on this waiver and be waived from payment of the maintenance fee. A notice of intent to hold for these sites is required to be filed by the December 30th following the filing of this waiver.

PHOENIX, ARIZONA

FOR OFFICIAL USE ONLY

2019 AUG 22 P 1:24

RECEIVED

BLM STATE OFFICE

UNITED STATES
DEPARTMENT OF THE INTERIOR
BUREAU OF LAND MANAGEMENT

FORM APPROVED
OMB NO.: 1004-0114
Expires: January 31, 2020

AFFIDAVIT OF ANNUAL ASSESSMENT WORK

AMC 440223

WHEN RECORDED, MAIL DOCUMENT TO:

NAME: RICHARD PANIAGUA

ADDRESS: 70 301

CITY, STATE, ZIP: SAN YER, MI 49125

FOR COUNTY RECORDER'S USE

No. of Claims 2
x \$10/claim
Total due BLM \$ 20.00

TO ALL WHOM IT MAY CONCERN:

1. The undersigned certifies that at least \$100 per claim was expended for development, labor and improvements, or equivalent value added, as the annual assessment work for the assessment year ending September 1, 2018 for the following contiguous unpatented mining claim(s), located in the County of MOHAVE, in the State of ARIZONA.

BLM Serial No.	Name of Claim	Tp	Rg	Sec	Mer	County Recordation Book and Page No.	Co. Recording Date
<u>AMC 440227</u>	<u>ROSE MINE</u>						
<u>AMC 440224</u>	<u>DARDANELLES</u>						

RECEIVED
BLM AZ STATE OFFICE
2019 JAN 28 P 1:25
PHOENIX, ARIZONA

#4362488

Entered 3/1/19 AD

2. Type of labor and improvements (specify what was done and give the total value for that labor and improvement to show at least \$100 for each claim). If a geological, geochemical, or geophysical survey was performed, as per 30 U.S.C. 28-1, reference the title of the report of survey, give cost and date of the survey and report, and indicate it was filed with the County Recorder:

Description of Work Performed	Value of Work Performed	Date Work Was Performed
CLEARED MINE ENTRANCE	100	9/2018
" " "	100	9/2018

3. Name and mailing address of each person who performed the labor and improvements:

Name (please print)

Current Mailing Address (please print)

JIM ADAMS

1465 ROSLIN RD. BENTON HARBOR, MI

4. Name and mailing address of each person who holds and claims the subject mining claim(s) for the valuable minerals contained therein. Be sure to indicate if there is a change of address:

Name (please print)

Current Mailing Address (please print)

RICK PANICAGUA

PO BOX 301 SAWYER, MI 49725

RECEIVED
 BLM ARIZONA STATE OFFICE
 2019 JAN 28 P 1:25
 PHOENIX, ARIZONA

5. The undersigned testifies that on the date of 9/18, 2018 all monuments required by law were erected upon the subject claim(s), and all notices required by law were posted on the subject claim(s) or copies thereof were in place, and at said date, each corner monument bore or contained

[Handwritten Signature]

12/15/18

**United States Department of the Interior
Bureau of Land Management**

Receipt

DIV OF LANDS, MINRLS & ENERGY
ONE N CENTRAL AVE
PHOENIX, AZ 85004 -4427
Phone: 602-417-9200

No: 4362688

Transaction #: 4479915	
Date of Transaction: 02/01/2019	
CUSTOMER:	
RICHARD PANIAGUA PO BOX 301 SAWYER, MI 49125-0301 US	

LINE #	QTY	DESCRIPTION	REMARKS	UNIT PRICE	TOTAL
1	1.00	LOCATABLE MINERALS / MINING CLAIMS- NOT NEW-UNADJUD, ONE AUTH NO. ONLY / MINING CLAIM MONEY RECEIVED CASES: AMC440227/\$20.00	POL 2018/2	- n/a -	20.00
TOTAL:					\$20.00

PAYMENT INFORMATION			
1	AMOUNT:	20.00	POSTMARKED: N/A
	TYPE:	CHECK	RECEIVED: 01/28/2019
	CHECK NO:	1219	
	NAME:	PANIAGUA, RICHARD 838 N GREENVIEW UNIT 1 CHICAGO IL 60642 US	

REMARKS
THERE HAS BEEN A FEE INCREASE / PLEASE SEE ENCLOSED FLYER / THANK YOU

This receipt was generated by the automated BLM Collections and Billing System and is a paper representation of a portion of the official electronic record contained therein.

*\$15 for Amc 440227
\$5 for Amc 440224 + \$10 from Receipt # 438064
\$5 earned manually 3/1/19 AD*

United States Department of the Interior
Bureau of Land Management
 DIV OF LANDS, MINRLS & ENERGY
 ONE N CENTRAL AVE
 PHOENIX, AZ 85004 -4427
 Phone: 602-417-9200

Receipt

No: 4380641

Transaction #: 4498098	
Date of Transaction: 02/25/2019	
CUSTOMER:	
RICHARD PANIAGUA PO BOX 301 SAWYER,MI 49125-0301 US	

LINE #	QTY	DESCRIPTION	REMARKS	UNIT PRICE	TOTAL
1	1.00	LOCATABLE MINERALS / MINING CLAIMS-NOT NEW-UNADJUD,ONE AUTH NO. ONLY / MINING CLAIM MONEY RECEIVED CASES: AMC440227/\$10.00	ADDITIONAL POL FEES	- n/a -	10.00
TOTAL:					\$10.00

PAYMENT INFORMATION			
1	AMOUNT:	10.00	POSTMARKED: N/A
	TYPE:	CHECK	RECEIVED: 02/22/2019
	CHECK NO:	1120	
	NAME:	PANIAGUA, RICHARD PO BOX 301 SAWYER MI 49125-0301 US	

REMARKS

This receipt was generated by the automated BLM Collections and Billing System and is a paper representation of a portion of the official electronic record contained therein.

*\$10 earned manually for Amc 440224 to \$5 from receipt # 4362688
AD 3/1/19*

United States Department of the Interior
Bureau of Land Management
 DIV OF LANDS, MINRLS & ENERGY
 ONE N CENTRAL AVE
 PHOENIX, AZ 85004 -4427
 Phone: 602-417-9200

Receipt

No: 4362688

Transaction #: 4479915	
Date of Transaction: 02/01/2019	
CUSTOMER:	
RICHARD PANIAGUA PO BOX 301 SAWYER, MI 49125-0301 US	

RECEIVED
 BLM PHOENIX OFFICE
 2019 FEB 22 PD 1:54
 PHOENIX, ARIZONA

LINE #	QTY	DESCRIPTION	REMARKS	UNIT PRICE	TOTAL
1	1.00	LOCATABLE MINERALS / MINING CLAIMS- NOT NEW-UNADJUD, ONE AUTH NO. ONLY / MINING CLAIM MONEY RECEIVED CASES: AMC440227/\$20.00	POL 2018/2	- n/a -	20.00
TOTAL:					\$20.00

PAYMENT INFORMATION			
1	AMOUNT:	20.00	POSTMARKED: N/A
	TYPE:	CHECK	RECEIVED: 01/28/2019
	CHECK NO:	1219	
	NAME:	PANIAGUA, RICHARD 838 N GREENVIEW UNIT 1 CHICAGO IL 60642 US	

REMARKS
THERE HAS BEEN A FEE INCREASE / PLEASE SEE ENCLOSED FLYER / THANK YOU

This receipt was generated by the automated BLM Collections and Billing System and is a paper representation of a portion of the official electronic record contained therein.

#4380641

4
017)

UNITED STATES
DEPARTMENT OF THE INTERIOR
BUREAU OF LAND MANAGEMENT

FORM APPROVED
OMB NO.: 1004-0114
Expires: January 31, 2020

AFFIDAVIT OF ANNUAL ASSESSMENT WORK

WHEN RECORDED, MAIL DOCUMENT TO:

NAME: RICHARD PANIAGUA

ADDRESS: 70 301

CITY, STATE, ZIP: SAVYER, MI 49125

FOR COUNTY RECORDER'S USE

No. of Claims 2
x \$10/claim
Total due BLM \$ 20.00

TO ALL WHOM IT MAY CONCERN:

1. The undersigned certifies that at least \$100 per claim was expended for development, labor and improvements, or equivalent value added, as the annual assessment work for the assessment year ending September 1, 2019 for the following contiguous unpatented mining claim(s), located in the County of MOHAVE, in the State of ARIZONA.

BLM Serial No.	Name of Claim	Tp	Re	Sec	Mer	County	Recording Book and Page No.	Co-Recording Date
AMC 440227	ROSE MINE							
AMC 440224	DARDANELLES							

PHOENIX ARIZONA
2019 JAN 28 P 1:25
RECEIVED
BLM AZ STATE OFFICE
PHOENIX, ARIZONA
2019 FEB 22 P 1:54
RECEIVED
BLM AZ STATE OFFICE

#4362488

IMPORTANT NOTICE

PROCESSING FEES FOR MINING CLAIM ACTIONS HAVE INCREASED

Effective October 1, 2018, the following fees associated with mining claims, have increased from \$10 per mining claim to \$15 per mining claim:

- Amendment
- Transfer of Interest
- Affidavit of Labor
- Notice of Intent to Hold

All documents filed with BLM on or after October 1, 2018, must pay the new fee at the time of filing.

This increase DOES NOT affect new mining claims. All fees associated with filing new mining claims remain the same at \$212 per 20 acre mining claim: PROCESSING FEE - \$20, LOCATION FEE - \$37, MAINTENANCE FEE - \$155 (per 20 acres or portion thereof)

Under the cost recovery rule, 70 FR 58857 (2005), the cost recovery fees at 43 CFR 3000.12 were updated in the Federal Register published on September 28, 2018, 83 FR 48957 (2018)

RECEIVED
BLM AZ STATE OFFICE
2019 FEB 22 P 1:54
PHOENIX, ARIZONA

February 16, 2019

✓ 11 20

Enclosed is a check in the amount of \$10.00, the deficiency noted in your letter, for

Claims:

AMC440227

AMC 440224.

Thank you.

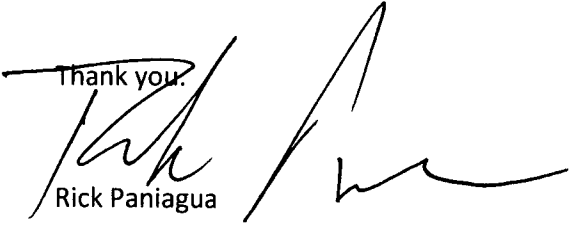
Rick Paniagua

RECEIVED
BLM AZ PHOENIX
2019 FEB 22 P 1:53
PHOENIX, ARIZONA

Pawitaja
PO 301
Sawyer, MI 49125

CAROL STREAM, IL

DEORA II



US DEPT. OF INTERIOR
BLM - DIV OF LAND MGMT.
ONE CENTRAL AVE
PHOENIX, AZ 85004-4427

PHOENIX, ARIZONA

2019 FEB 22 P 1:53

RECEIVED
BLM AZ STATE OFFICE

8500484427 0041



United States Department of the Interior
Bureau of Land Management
 DIV OF LANDS, MINRLS & ENERGY
 ONE N CENTRAL AVE
 PHOENIX, AZ 85004 -4427
 Phone: 602-417-9200

Receipt

No: 4380641

Transaction #: 4498098	
Date of Transaction: 02/25/2019	
CUSTOMER:	
RICHARD PANIAGUA PO BOX 301 SAWYER,MI 49125-0301 US	

LINE #	QTY	DESCRIPTION	REMARKS	UNIT PRICE	TOTAL
1	1.00	LOCATABLE MINERALS / MINING CLAIMS-NOT NEW-UNADJUD,ONE AUTH NO. ONLY / MINING CLAIM MONEY RECEIVED CASES: AMC440227/\$10.00	ADDITIONAL POL FEES	- n/a -	10.00
TOTAL:					\$10.00

PAYMENT INFORMATION			
1	AMOUNT:	10.00	POSTMARKED: N/A
	TYPE:	CHECK	RECEIVED: 02/22/2019
	CHECK NO:	1120	
	NAME:	PANIAGUA, RICHARD PO BOX 301 SAWYER MI 49125-0301 US	

REMARKS

This receipt was generated by the automated BLM Collections and Billing System and is a paper representation of a portion of the official electronic record contained therein.

This receipt was generated by the automated BLM Collections and Billing System and is a paper representation of a portion of the official electronic record contained therein.

UNITED STATES
DEPARTMENT OF THE INTERIOR
BUREAU OF LAND MANAGEMENT

MAINTENANCE FEE WAIVER CERTIFICATION

SEE INSTRUCTIONS ON PAGE 2

490

AMC 440223
~~312359~~

FORM APPROVED
OMB NO. 1004-0114
Expires: January 31, 2020

1. This small miner waiver is filed for the assessment year beginning on September 1, 2018 and ending on September 1, 2019.
2. The undersigned and all related parties owned ten or fewer mining claims, mill, or tunnel sites located and maintained on Federal lands in the United States of America on September 1, 2018.
3. The undersigned have performed the assessment work required by law for each mining claim listed prior to filing this waiver and understand that by filing this form, the undersigned must file an affidavit of assessment work with the Bureau of Land Management (BLM) by the December 30th following the filing of this waiver.
4. The undersigned understand that if the assessment work obligation has not yet come due under 30 U.S.C. 28 (for those claims in their first assessment year only), a notice of intent to hold reciting this condition must be recorded by the December 30th following the filing of this waiver.
5. The undersigned understand that mill and tunnel sites may also be listed on this waiver and be waived from payment of the maintenance fee, and that a notice of intent to hold for these sites is required to be filed with the BLM by the December 30th following the filing of this waiver.
6. The undersigned understand and acknowledge that pursuant to 43 U.S.C. 1212 and 18 U.S.C. 1001, the filing or recording of a false, fictitious, or fraudulent document with the BLM may result in a fine of up to \$250,000, a prison term not to exceed five years, or both.
7. The mining claims, mill or tunnel sites for which this waiver from payment of the maintenance fees is requested are:

CLAIM OR SITE NAME	BLM RECORDATION SERIAL NUMBER
1. DARDANELLES	AMC 440224 (5913)
2. ROSE MINE	AMC 440227
3. TIN CUP	WMC 312367
4.	
5.	
6.	
7.	
8.	
9.	
10.	

RECEIVED
BLM AZ STATE OFFICE
2018 AUG 28 P 12:58
PHOENIX, ARIZONA

The owner(s) (claimants) of the above mining claims and sites are:

RICHARD PANIAGUA
(Owner's Name - Please Print)
PO 301, ~~SACRED, AZ 85915~~
(Owner's Mailing Address)

[Signature]
(Owner's Signature)
SAWYER MI 49125
(City) (State) (Zip Code)

(Owner's Name - Please Print)

(Owner's Signature)

(Owner's Mailing Address)

(City) (State) (Zip Code)

(Owner's Name - Please Print)

(Owner's Signature)

(Owner's Mailing Address)

(City) (State) (Zip Code)

(Owner's Name - Please Print)

(Owner's Signature)

(Owner's Mailing Address)

(City) (State) (Zip Code)

483
INTEREST
SEP 10 2013
BY: *[Signature]*

[Handwritten initials]

PANIAGUA
PO 301
SAWYER

RECEIVED
BLM AZ STATE OFFICE

2018 AUG 28 P 12:58

PHOENIX, ARIZONA

49125

CAROL STREAM IL 601

23 AUG 2018 PM 7 L



US DEPT. OF INTERIOR
BLM - DIV. OF MINERALS
ONE NORTH CENTRAL AVE
SUITE 800
PHOENIX, AZ 85004-4427

85004-442700



433

SC

440223

Form 3830-2
(January 2017)

UNITED STATES
DEPARTMENT OF THE INTERIOR
BUREAU OF LAND MANAGEMENT

MAINTENANCE FEE WAIVER CERTIFICATION

FORM APPROVED
OMB NO. 1004-0114
Expires: January 31, 2020

SEE INSTRUCTIONS ON PAGE 2

1. This small miner waiver is filed for the assessment year beginning on September 1, 2018 and ending on September 1, 2019 ^{SC}
2. The undersigned and all related parties owned ten or fewer mining claims, mill, or tunnel sites located and maintained on Federal lands in the United States of America on September 1, 2018 ^{SC}
3. The undersigned have performed the assessment work required by law for each mining claim listed prior to filing this waiver and understand that by filing this form, the undersigned must file an affidavit of assessment work with the Bureau of Land Management (BLM) by the December 30th following the filing of this waiver.
4. The undersigned understand that if the assessment work obligation has not yet come due under 30 U.S.C. 28 (for those claims in their first assessment year only), a notice of intent to hold reciting this condition must be recorded by the December 30th following the filing of this waiver.
5. The undersigned understand that mill and tunnel sites may also be listed on this waiver and be waived from payment of the maintenance fee, and that a notice of intent to hold for these sites is required to be filed with the BLM by the December 30th following the filing of this waiver.
6. The undersigned understand and acknowledge that pursuant to 43 U.S.C. 1212 and 18 U.S.C. 1001, the filing or recording of a false, fictitious, or fraudulent document with the BLM may result in a fine of up to \$250,000, a prison term not to exceed five years, or both.
7. The mining claims, mill or tunnel sites for which this waiver from payment of the maintenance fees is requested are:

CLAIM OR SITE NAME	BLM RECORDATION SERIAL NUMBER
1. <u>TIN CUP</u>	WMC 312 367
2. <u>ROSE MINE</u>	<u>AMC 440 227 (913)</u>
3. <u>DARDANELLES</u>	<u>AMC 440 224</u>
4.	
5.	
6.	
7.	
8.	
9.	
10.	

The owner(s) (claimants) of the above mining claims and sites are:

2 & RICHARD PANIAGUA
 (Owner's Name - Please Print)
PO 301
 (Owner's Mailing Address) ✓

[Signature]
 (Owner's Signature)
SAWYER MI 49125
 (City) (State) (Zip Code)

 (Owner's Name - Please Print)

 (Owner's Mailing Address)

 (Owner's Name - Please Print)

 (Owner's Mailing Address)

 (Owner's Name - Please Print)

 (Owner's Mailing Address)

 (Owner's Signature)

 (City) (State) (Zip Code)

 (Owner's Signature)

 (City) (State) (Zip Code)

 (Owner's Signature)

 (City) (State) (Zip Code)

(Continued on page 2)

RECEIVED

AUG 27 2018

BLM-WY STATE OFFICE

RECEIVED
 BLM AZ STATE OFFICE
 2018 AUG 29 P 2:53
 PHOENIX, ARIZONA

Copy 2

24/PB

(Owner's Name - Please Print)	(Owner's Signature)
(Owner's Mailing Address)	(City) (State) (Zip Code)
(Owner's Name - Please Print)	(Owner's Signature)
(Owner's Mailing Address)	(City) (State) (Zip Code)
(Owner's Name - Please Print)	(Owner's Signature)
(Owner's Mailing Address)	(City) (State) (Zip Code)
(Owner's Name - Please Print)	(Owner's Signature)
(Owner's Mailing Address)	(City) (State) (Zip Code)

18 U.S.C. 1001 and 43 U.S.C. 1212 make it a crime for any person knowingly and willfully to make to any department or agency of the United States any false, fictitious or fraudulent statements or representations as to any matter within its jurisdiction.

INSTRUCTIONS

1. This certification is made under the provisions of 43 U.S.C. § 1744 and 30 U.S.C. §28-28k and the regulations thereunder (43 CFR Part 3830).
2. The claimant(s) must fill in the dates in paragraph 1 for the beginning and ending of the assessment year for which this waiver is sought.
3. The claimant(s) must fill in the date in paragraph 2 for the beginning of the assessment year for which this waiver is sought.
4. All claim and site names and BLM serial numbers must be listed for the mining claims, mill sites, and tunnel sites for which the waiver is sought.
5. All owners of the mining claims, mill sites, and tunnel sites and their addresses must be given.
6. This waiver form must be signed by all the claimants or their designated agent, in original form. If an agent is designated, a notarized designation of agent, signed by all of the claimants with proper address given, must be submitted with this waiver.
7. This form must be filed no later than September 1st for the upcoming assessment year in the BLM State Office where the mining claims or sites are recorded, or the waiver cannot be granted by the BLM. (Example: To obtain a waiver for the assessment year 2012, which begins on September 1, 2011, you must qualify for and file for a waiver no later than September 1, 2011, in the proper BLM State Office.)
8. For all mining claims which require assessment work, you must record an affidavit of labor on or before the December 30th immediately following the filing of this waiver. For all other mining claims or sites waived, you must record a notice of intent to hold on or before the December 30th immediately following the filing of this waiver.
9. Mill and tunnel sites may also be listed on this waiver and be waived from payment of the maintenance fee. A notice of intent to hold for these sites is required to be filed by the December 30th following the filing of this waiver.

RECEIVED
AUG 27 2018

FOR OFFICIAL USE ONLY

RECEIVED
BLM ARIZONA STATE OFFICE
PHOENIX, ARIZONA
2018 AUG 29 P 2:53

RECEIVED
BLM AZ STATE OFFICE

2018 AUG 29 P 2:53

CAROL STREMM IL 601

23 AUG 2018 PM 7 L



PANIAOA
PO 301
SAWYER, MI 49125

US. DEPT OF INTERIOR
BLM - DIV OF MINERALS
PO Box 1828
CHEYENNE, WY 82003

82003-182828



AMC 440223

When Recorded Return Document to:

Kenneth Tallmage
3969 N. Elgin rd.
Golden Valley, AZ. 86413

Check here is this is a change of address.

Telephone: 928-249-4232

E-mail address: KTallmage@yahoo.com

AFFIDAVIT OF PERFORMANCE OF ANNUAL WORK

1. State of Arizona, County of Mohave ss:

2. I (Name) Ken Tallmage

3. Reside at (Address) 3969 N. Elgin rd

City Golden Valley County Mohave

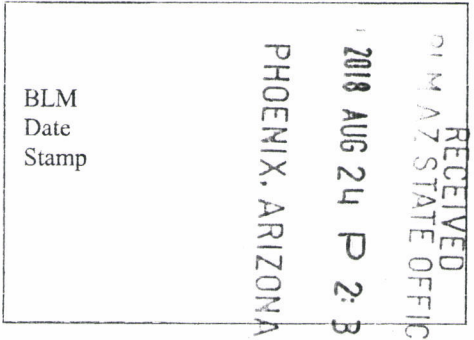

State AZ Zip 86413 being duly sworn, depose and say that I am a citizen of the United States, more than eighteen years of age, and that all of the facts set forth in this affidavit, subject to the provisions and penalties of 18 U.S.C. 1001 pertaining to the filing of false, fictitious, or fraudulent statements with the United States, are true and correct according to the best of my knowledge, information and belief.

4. Owner's name and address (If not shown in Items 1-3 above).

5. That I am personally acquainted with the mining claim(s). The work and improvements were made by and at the expense of the owner(s) of said claim(s). Said contiguous group of claims, listed on this document, are situated in the

(optional) Mining District; Mohave County, Arizona.

Line No.	AMC NUMBER	CLAIM/SITE NAME	COUNTY RECORDER DATA (If available)	TWP	RNG	SEC
1	440228	South Pilgrim		23N	20W	13
2						
3						
4						
5						
6						

Form: MCF108
Revised July 2014
Page 1 of 2

ENTERED
AUG 30 2018
BY: [Signature]

BLM
Date
Stamp

PHOENIX, ARIZONA

2018 AUG 24 P 2:31

RECEIVED
AZ STATE OFFICE

7					
8					
9					
10					

6. That between the dates starting at 12 o'clock noon on September 1, 20 17 and ending at 12 o'clock noon on September 1, 20 18 at least \$ 500.00 dollars worth of work and improvements were done and performed upon said claim(s) or upon one or more of a contiguous group of claims for the benefit of all, wholly or partly outside of a contiguous group of claims for the benefit of all, not including the location work.

7. That the following persons were employed to perform the work and improvements described herein: Kenneth Tallmage

8. That the work and improvements performed were: access road improvements, washed out roads repaired, mine access improved

9. Dated: 8/24/18 Signature: Kenneth Tallmage

SUBSCRIBED AND SWORN TO before me, a Notary Public, this 24 day of August 20 18

By: Kenneth Tallmage

Notary Public Philip D'Amore

My Commission Expires 3-1-2020

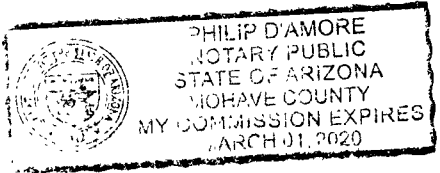

Bureau of Land Management
Arizona State Office
www.blm.gov/az

No. of Claims: 1 x \$10 = 10⁰⁰
 Check No.: _____ Init. PER
 Receipt No.: 4243962
 For BLM Use Only

United States Department of the Interior
Bureau of Land Management
 DIV OF LANDS, MINRLS & ENERGY
 ONE N CENTRAL AVE
 PHOENIX, AZ 85004 -4427
 Phone: 602-417-9200

Receipt

No: 4243962

Transaction #: 4359409	
Date of Transaction: 08/24/2018	
CUSTOMER:	
KENNETH TALLMAGE 3969 N ELGIN RD GOLDEN VALLEY, AZ 86413-5989 US	

LINE #	QTY	DESCRIPTION	REMARKS	UNIT PRICE	TOTAL
1	1.00	LOCATABLE MINERALS / MINING CLAIMS-NOT NEW-UNADJUD, ONE AUTH NO. ONLY / MINING CLAIM MONEY RECEIVED CASES: AMC440228/\$10.00		- n/a -	10.00
TOTAL:					\$10.00

PAYMENT INFORMATION					
1	AMOUNT:	10.00	POSTMARKED:	N/A	
	TYPE:	CASH	RECEIVED:	08/24/2018	
	NAME:	TALLMAGE, KENNETH 3969 N ELGIN RD GOLDEN VALLEY AZ 86413-5989 US			

REMARKS

This receipt was generated by the automated BLM Collections and Billing System and is a paper representation of a portion of the official electronic record contained therein.

DEPARTMENT OF THE INTERIOR
BUREAU OF LAND MANAGEMENT
MINING CLAIMS

Run Date/Time: 9/11/2018

MC Maintenance Fees Paid Through the BLM Pay Portal
(by Date Paid)

Page 362 Of 723

CBS Receipt: 4248102

Printed For Lead File # AMC440223

Agency Tracking ID: 1535477873

Assessment Year: 2019

Number of BLM Serial Nr: 29

Paid On: 8/28/2018

Total Amount Paid: \$4,495.00

Claim Name	BLM Serial No	Lead File No	Amount Paid
BLACK GOLD	AMC438326	AMC438326	\$155.00
FLAG	AMC439949	AMC439949	\$155.00
C.O.D.	AMC440223	AMC440223	\$155.00
ARIZONA RAND	AMC440245	AMC440245	\$155.00
JIMMIE	AMC440536	AMC440526	\$155.00
LUCKY BOY	AMC440538	AMC440526	\$155.00
NEW STANDARD	AMC440540	AMC440526	\$155.00
NEW STANDARD EXT	AMC440541	AMC440526	\$155.00
ST LOUIS	AMC440544	AMC440526	\$155.00
TELLURIDE CHIEF	AMC440545	AMC440526	\$155.00
VERDE COMBINATION	AMC440548	AMC440526	\$155.00
YELLOW BREAST	AMC440549	AMC440526	\$155.00
GOLDEN BELT	AMC440552	AMC440552	\$155.00
GOLDEN TURKEY	AMC440553	AMC440552	\$155.00
APEX	AMC441153	AMC441153	\$155.00
GREEN STREAK	AMC441154	AMC441153	\$155.00
TALLEY	AMC441155	AMC441153	\$155.00
CARMELITA	AMC442190	AMC442189	\$155.00
FOUR PEAKS	AMC442191	AMC442189	\$155.00
FOUR PEAKS EXT	AMC442192	AMC442189	\$155.00
GREAT BEAR	AMC442193	AMC442189	\$155.00
JASPER	AMC442194	AMC442189	\$155.00
ALASKAN	AMC443323	AMC443322	\$155.00
PLAMOSA	AMC443330	AMC443322	\$155.00

NO WARRANTY IS MADE BY BLM FOR USE OF THE DATA FOR PURPOSES NOT INTENDED BY BLM

DEPARTMENT OF THE INTERIOR
BUREAU OF LAND MANAGEMENT
MINING CLAIMS

Run Date/Time: 9/11/2018

MC Maintenance Fees Paid Through the BLM Pay Portal
(by Date Paid)

Page 363 Of 723

CARMELITA 1	AMC444671	AMC444671	\$155.00
CARMELITA 2	AMC444672	AMC444671	\$155.00
GOLDEN TURKEY 1	AMC447861	AMC447861	\$155.00
GOLDEN TURKEY 2	AMC447862	AMC447861	\$155.00
NEW STANDARD 1	AMC451012	AMC451012	\$155.00

United States Department of the Interior
Bureau of Land Management
 BUSINESS & SUPPORT SVCS DIV
 ONE N CENTRAL AVE SUITE 800
 PHOENIX, AZ 85004 -4427
 Phone: 602-417-9200

Receipt

No: 4248102

Transaction #: 4363576	
Date of Transaction: 08/28/2018	
CUSTOMER:	
JESSICA SHUMAN 1995 RIVER RUN DRIVE HUNTSVILLE, CT 84317 US	

LINE #	QTY	DESCRIPTION	REMARKS	UNIT PRICE	TOTAL
1	1.00	LOCATABLE MINERALS / MINING CLAIMS- NOT NEW-UNADJUD, ONE AUTH NO. ONLY / MINING CLAIM MONEY RECEIVED CASES: AMC439949/\$4495.00		- n/a -	4495.00
TOTAL:					\$4,495.00

PAYMENT INFORMATION				
NOTE: Items will appear on credit card statement as "BLM O Mining Claim".				
1	AMOUNT:	4495.00	POSTMARKED:	N/A
	TYPE:	CREDIT CARD	RECEIVED:	08/28/2018
	NAME:	JESSICA SHUMAN 1995 RIVER RUN DRIVE HUNTSVILLE CT 84317 US		
	CARD NO:	XXXXXXXXXXXX3699	AUTH CODE:	029750
	NAME ON CARD:	JESSICA SHUMAN		
	SIGNATURE:			

REMARKS

This receipt was generated by the automated BLM Collections and Billing System and is a paper representation of a portion of the official electronic record contained therein.

UNITED STATES
DEPARTMENT OF THE INTERIOR
BUREAU OF LAND MANAGEMENT

327 PE

440223

MAINTENANCE FEE WAIVER CERTIFICATION

FORM APPROVED
OMB NO. 1004-0114
Expires: January 31, 2020

SEE INSTRUCTIONS ON PAGE 2

1. This small miner waiver is filed for the assessment year beginning on September 1, 2018 and ending on September 1, 2019.
2. The undersigned and all related parties owned ten or fewer mining claims, mill, or tunnel sites located and maintained on Federal lands in the United States of America on September 1, 2018.
3. The undersigned have performed the assessment work required by law for each mining claim listed prior to filing this waiver and understand that by filing this form, the undersigned must file an affidavit of assessment work with the Bureau of Land Management (BLM) by the December 30th following the filing of this waiver.
4. The undersigned understand that if the assessment work obligation has not yet come due under 30 U.S.C. 28 (for those claims in their first assessment year only), a notice of intent to hold reciting this condition must be recorded by the December 30th following the filing of this waiver.
5. The undersigned understand that mill and tunnel sites may also be listed on this waiver and be waived from payment of the maintenance fee, and that a notice of intent to hold for these sites is required to be filed with the BLM by the December 30th following the filing of this waiver.
6. The undersigned understand and acknowledge that pursuant to 43 U.S.C. 1212 and 18 U.S.C. 1001, the filing or recording of a false, fictitious, or fraudulent document with the BLM may result in a fine of up to \$250,000, a prison term not to exceed five years, or both.
7. The mining claims, mill or tunnel sites for which this waiver from payment of the maintenance fees is requested are:

CLAIM OR SITE NAME	BLM RECORDATION SERIAL NUMBER
1. South Pilgrim	AMC440228 (913)
2.	
3.	
4.	
5.	
6.	
7.	
8.	
9.	
10.	

The owner(s) (claimants) of the above mining claims and sites are:

<u>Kenneth Tallmage</u> (Owner's Name - Please Print)	<u>Kenneth Tallmage</u> (Owner's Signature)
<u>3969 N. Elgin rd.</u> (Owner's Mailing Address)	<u>Golden Valley</u> <u>AZ</u> <u>86413</u> (City) (State) (Zip Code)
_____ (Owner's Name - Please Print)	_____ (Owner's Signature)
_____ (Owner's Mailing Address)	_____ (City) (State) (Zip Code)
_____ (Owner's Name - Please Print)	_____ (Owner's Signature)
_____ (Owner's Mailing Address)	_____ (City) (State) (Zip Code)
_____ (Owner's Name - Please Print)	_____ (Owner's Signature)
_____ (Owner's Mailing Address)	_____ (City) (State) (Zip Code)

(Continued on page 2)

ENTERED
SEP 12 2018
BY: BOS

RECEIVED
PHOENIX, ARIZONA
2018 AUG 24 P 2:31
BLM AZ STATE OFFICE

(Owner's Name - Please Print)	(Owner's Signature)		
(Owner's Mailing Address)	(City)	(State)	(Zip Code)
(Owner's Name - Please Print)	(Owner's Signature)		
(Owner's Mailing Address)	(City)	(State)	(Zip Code)
(Owner's Name - Please Print)	(Owner's Signature)		
(Owner's Mailing Address)	(City)	(State)	(Zip Code)
(Owner's Name - Please Print)	(Owner's Signature)		
(Owner's Mailing Address)	(City)	(State)	(Zip Code)

18 U.S.C. 1001 and 43 U.S.C. 1212 make it a crime for any person knowingly and willfully to make to any department or agency of the United States any false, fictitious or fraudulent statements or representations as to any matter within its jurisdiction.

INSTRUCTIONS

1. This certification is made under the provisions of 43 U.S.C. § 1744 and 30 U.S.C. §28-28k and the regulations thereunder (43 CFR Part 3830).
2. The claimant(s) must fill in the dates in paragraph 1 for the beginning and ending of the assessment year for which this waiver is sought.
3. The claimant(s) must fill in the date in paragraph 2 for the beginning of the assessment year for which this waiver is sought.
4. All claim and site names and BLM serial numbers must be listed for the mining claims, mill sites, and tunnel sites for which the waiver is sought.
5. All owners of the mining claims, mill sites, and tunnel sites and their addresses must be given.
6. This waiver form must be signed by all the claimants or their designated agent, in original form. If an agent is designated, a notarized designation of agent, signed by all of the claimants with proper address given, must be submitted with this waiver.
7. This form must be filed no later than September 1st for the upcoming assessment year in the BLM State Office where the mining claims or sites are recorded, or the waiver cannot be granted by the BLM. (Example: To obtain a waiver for the assessment year 2012, which begins September 1, 2011, you must qualify for and file for a waiver no later than September 1, 2011, in the proper BLM State Office.)
8. For all mining claims which require assessment work, you must record an affidavit of labor on or before the December 30th immediately following the filing of this waiver. For all other mining claims or sites waived, you must record a notice of intent to hold on or before the December 30th immediately following the filing of this waiver.
9. Mill and tunnel sites may also be listed on this waiver and be waived from payment of the maintenance fee. A notice of intent to hold for these sites is required to be filed by the December 30th following the filing of this waiver.

RECEIVED
 BLM STATE OFFICE
 PHOENIX ARIZONA
 2011 AUG 24 P 2: 31

FOR OFFICIAL USE ONLY

Run Date: 09/05/17

Run Time: 02:33 PM

**DEPARTMENT OF THE INTERIOR
BUREAU OF LAND MANAGEMENT
MINING CLAIMS**

MC Maintenance Fees Paid Through the BLM Pay Portal

CBS Receipt: 3963816

Printed For Lead File # AMC440223

Agency Tracking ID: 1503920070

Assessment Year: 2018

Number of BLM Serial Nr: 2

Paid On: 08/28/2017

Total Amount Paid: \$310.00

Claim Name	BLM Serial No	Lead File No	Amount Paid
PEGRIN MINE	AMC435947	AMC435946	\$155.00
INAUGURATION	AMC440226	AMC440223	\$155.00

United States Department of the Interior
Bureau of Land Management
 BUSINESS & SUPPORT SVCS DIV
 ONE N CENTRAL AVE SUITE 800
 PHOENIX, AZ 85004 -4427
 Phone: 602-417-9200

Receipt

No: 3963816

Transaction #: 4073689	
Date of Transaction: 08/28/2017	
CUSTOMER:	
JERI VICTORIA FORGA 205 CASTLE DR ATWATER,CA 95301 US	

LINE #	QTY	DESCRIPTION	REMARKS	UNIT PRICE	TOTAL
1	1.00	LOCATABLE MINERALS / MINING CLAIMS- NOT NEW-UNADJUD,ONE AUTH NO. ONLY / MINING CLAIM MONEY RECEIVED CASES: AMC435947/\$310.00		- n/a -	310.00
TOTAL:					\$310.00

PAYMENT INFORMATION			
NOTE: Items will appear on credit card statement as "BLM O Mining Claim".			
1	AMOUNT:	310.00	POSTMARKED: N/A
	TYPE:	CREDIT CARD	RECEIVED: 08/28/2017
	NAME:	JERI VICTORIA FORGA 205 CASTLE DR ATWATER CA 95301 US	
	CARD NO:	XXXXXXXXXXXX6407	AUTH CODE: 165164
	NAME ON CARD:	JERI VICTORIA FORGA	
	EXPIRES:	05/2021	
	SIGNATURE:		

REMARKS

This receipt was generated by the automated BLM Collections and Billing System and is a paper representation of a portion of the official electronic record contained therein.

Run Date: 08/28/17

Run Time: 12:44 PM

**DEPARTMENT OF THE INTERIOR
BUREAU OF LAND MANAGEMENT
MINING CLAIMS**

MC Maintenance Fees Paid Through the BLM Pay Portal

CBS Receipt: 3953894

Printed For Lead File # AMC440223

Agency Tracking ID: 1503488439

Number of BLM Serial Nr: 1

Assessment Year: 2018

Paid On: 08/23/2017

Total Amount Paid: \$155.00

Claim Name	BLM Serial No	Lead File No	Amount Paid
PEACOCK	AMC440225	AMC440223	\$155.00

United States Department of the Interior
Bureau of Land Management
 BUSINESS & SUPPORT SVCS DIV
 ONE N CENTRAL AVE SUITE 800
 PHOENIX, AZ 85004 -4427
 Phone: 602-417-9200

Receipt

No: 3953894

Transaction #: 4063641	
Date of Transaction: 08/23/2017	
CUSTOMER:	
STEVEN B HULL 7460 WINONA COURT WESTMINSTER, CO 80030 US	

LINE #	QTY	DESCRIPTION	REMARKS	UNIT PRICE	TOTAL
1	1.00	LOCATABLE MINERALS / MINING CLAIMS- NOT NEW-UNADJUD, ONE AUTH NO. ONLY / MINING CLAIM MONEY RECEIVED CASES: AMC440225/\$155.00		- n/a -	155.00
TOTAL:					\$155.00

PAYMENT INFORMATION				
NOTE: Items will appear on credit card statement as "BLM O Mining Claim".				
1	AMOUNT:	155.00	POSTMARKED:	N/A
	TYPE:	CREDIT CARD	RECEIVED:	08/23/2017
	NAME:	STEVEN B HULL 7460 WINONA COURT WESTMINSTER CO 80030 US		
	CARD NO:	XXXXXXXXXXXX2959	AUTH CODE:	011725
	NAME ON CARD:	STEVEN B HULL		
	EXPIRES:	08/2019		
	SIGNATURE:			

REMARKS

This receipt was generated by the automated BLM Collections and Billing System and is a paper representation of a portion of the official electronic record contained therein.

Run Date: 08/21/17

Run Time: 09:47 AM

**DEPARTMENT OF THE INTERIOR
BUREAU OF LAND MANAGEMENT
MINING CLAIMS**

MC Maintenance Fees Paid Through the BLM Pay Portal

CBS Receipt: 3941187

Printed For Lead File # AMC440223

Agency Tracking ID: 1502923586

Assessment Year: 2018

Number of BLM Serial Nr: 2

Paid On: 08/16/2017

Total Amount Paid: \$310.00

Claim Name	BLM Serial No	Lead File No	Amount Paid
DARDANELLES	AMC440224	AMC440223	\$155.00
ROSE	AMC440227	AMC440223	\$155.00

United States Department of the Interior
Bureau of Land Management
 BUSINESS & SUPPORT SVCS DIV
 ONE N CENTRAL AVE SUITE 800
 PHOENIX, AZ 85004 -4427
 Phone: 602-417-9200

Receipt

No: 3941187

Transaction #: 4050849	
Date of Transaction: 08/16/2017	
CUSTOMER:	
	RICK PANIAGUA PO 301 SAWYER,MI 49125 US

LINE #	QTY	DESCRIPTION	REMARKS	UNIT PRICE	TOTAL
1	1.00	LOCATABLE MINERALS / MINING CLAIMS- NOT NEW-UNADJUD, ONE AUTH NO. ONLY / MINING CLAIM MONEY RECEIVED CASES: AMC440224/\$310.00		- n/a -	310.00
TOTAL:					\$310.00

PAYMENT INFORMATION			
NOTE: Items will appear on credit card statement as "BLM O Mining Claim".			
1	AMOUNT:	310.00	POSTMARKED: N/A
	TYPE:	CREDIT CARD	RECEIVED: 08/16/2017
	NAME:	RICK PANIAGUA PO 301 SAWYER MI 49125 US	
	CARD NO:	XXXXXXXXXXXX2006	AUTH CODE: 188054
	NAME ON CARD:	RICK PANIAGUA	
	EXPIRES:	01/2020	
	SIGNATURE:		

REMARKS

This receipt was generated by the automated BLM Collections and Billing System and is a paper representation of a portion of the official electronic record contained therein.

Run Date: 07/20/17

Run Time: 10:48 AM

**DEPARTMENT OF THE INTERIOR
BUREAU OF LAND MANAGEMENT
MINING CLAIMS**

MC Maintenance Fees Paid Through the BLM Pay Portal

CBS Receipt: 3884443

Printed For Lead File # AMC440223

Agency Tracking ID: 1499711440

Assessment Year: 2018

Number of BLM Serial Nr: 6

Paid On: 07/10/2017

Total Amount Paid: \$930.00

Claim Name	BLM Serial No	Lead File No	Amount Paid
FLAG	AMC439949	AMC439949	\$155.00
C.O.D.	AMC440223	AMC440223	\$155.00
LUCKY BOY	AMC440538	AMC440526	\$155.00
GOLDEN BELT	AMC440552	AMC440552	\$155.00
ARRASTRA	AMC443324	AMC443322	\$155.00
ARRASTRA	AMC443325	AMC443322	\$155.00

United States Department of the Interior
Bureau of Land Management
 BUSINESS & SUPPORT SVCS DIV
 ONE N CENTRAL AVE SUITE 800
 PHOENIX, AZ 85004 -4427
 Phone: 602-417-9200

Receipt

No: 3884443

Transaction #: 3993624	
Date of Transaction: 07/10/2017	
CUSTOMER:	
CRYSTAL SUTTON 2091 E MURRAY HOLLADAY RD SLC,UT 84117 US	

LINE #	QTY	DESCRIPTION	REMARKS	UNIT PRICE	TOTAL
1	1.00	LOCATABLE MINERALS / MINING CLAIMS- NOT NEW-UNADJUD, ONE AUTH NO. ONLY / MINING CLAIM MONEY RECEIVED CASES: AMC443324/\$930.00		- n/a -	930.00
TOTAL:					\$930.00

PAYMENT INFORMATION			
NOTE: Items will appear on credit card statement as "BLM O Mining Claim".			
1	AMOUNT:	930.00	POSTMARKED: N/A
	TYPE:	CREDIT CARD	RECEIVED: 07/10/2017
	NAME:	CRYSTAL SUTTON 2091 E MURRAY HOLLADAY RD SLC UT 84117 US	
	CARD NO:	XXXXXXXXXXXX4138	AUTH CODE: 029274
	NAME ON CARD:	CRYSTAL SUTTON	
	EXPIRES:	12/2019	
	SIGNATURE:		

REMARKS

This receipt was generated by the automated BLM Collections and Billing System and is a paper representation of a portion of the official electronic record contained therein.

NOTICE!!

These documents have been scanned!

Do not place un-scanned documents beneath this notice!

Do not remove this notice from this file!

GPO Jacket No. 560-102
Print Order 61540
Rise Business Services, LLC
Job=AZ15 5/1/2019



Box Number= AZ15013



Claim Begin-End: AMC440223-AMC440228

5 Miscellaneous



AZ15013-7

AMC440098-AMC440515

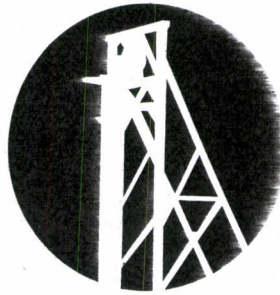

11/9/2016

GOLD RUSH EXPEDITIONS

GRE, Inc.
2091 E. Murray Holladay Road
Suite #22E
SLC, UT 84117

RUSH

ARIZONA BLM

Re: ^{SIX}~~FIVE~~ Notice of Location(s)

Dear ARIZONA BLM Cashier,

Please find enclosed ^{SIX}~~FIVE~~ Notice of location (s) for filing. I understand there is a fee for recording each of these documents. I have enclosed a check for the fees. Please apply the appropriate amount owed for filing fees and send a receipt with the recorded documents.

I have also enclosed a postage paid envelope for the document(s) to be returned.

Thank you for your time and efforts.

Sincerely,

GRE Accounting
385-218-2138
accounting@goldrushexpeditions.com
www.goldrushexpeditions.com

RECEIVED
BLM AZ STATE OFFICE
2016 NOV 15 P 1:55
PHOENIX, ARIZONA

NOTICE!!

These documents have been scanned!

Do not place un-scanned documents beneath this notice!

Do not remove this notice from this file!

GPO Jacket No. 560-102
Print Order 61540
Rise Business Services, LLC
Job=AZ15 5/1/2019



Box Number= AZ15013



Claim Begin-End: AMC440223-AMC440228

6 Location Notices-Amendments and Supporting Documents



AZ15013-7

AMC440098-AMC440515

MINING CLAIM STATUS REPORT

Data Entered: 22 Nov 16

MTP Checked By: [Signature]

GEO Checked By: [Signature]

LEAD SERIAL NUMBER: AMC 440223 thru AMC 440228

NUMBER OF CLAIMS & TYPE:

6 LODE
____ PLACER
____ ASSOCIATION PLACER
____ MILL SITE
____ TUNNEL SITE

CHARGES:

Location Fee @ \$37 = \$ _____
Processing Fee @ \$20 = \$ _____
Maintenance Fee @ \$155 = \$ _____
Add'l Maint Fee for Assoc Placer = \$ _____
SUBTOTAL \$ _____
Other Fees \$ _____
Other Fees \$ _____
TOTAL \$ _____

TOTAL ACREAGE: _____ Per Claim
(Placer Only)

NUMBER OF LOCATORS: _____

DOCUMENTS RECEIVED VIA: Over-the-Counter [] Mail TIMELY FILED: Yes No []

LEGAL DESCRIPTION:	T	R	SEC	
	<u>23N</u>	<u>20W</u>	<u>13</u>	
	<u>23N</u>	<u>17W</u>	<u>28</u>	<u>33</u>
	<u>24N</u>	<u>18W</u>	<u>34</u>	
	<u>23N</u>	<u>14W</u>	<u>8</u>	
	<u>22N</u>	<u>18W</u>	<u>12</u>	
	<u>19N</u>	<u>20W</u>	<u>10</u>	

BLM [] FOREST SERVICE [] SUBJ TO PL 359: Yes [] No []
WILDERNESS AREA []

SPLIT ESTATE: N/A [] SX [] PX [] OTHER []
SRHA [] Was proper Notice filed if located on SHRA Land? Yes [] No []

RECONVEYED MINERALS ON BLM LAND REQUIRE OPENING ORDER FROM 1944 TO 1993:

Open to Entry On _____ N/A []

COMMENTS/STATUS: VOID [] PARTIALLY VOID [] PVT MINERALS [] WITHDRAWN LANDS []
OTHER [] 440224 TIE-TO IS FROM T. 24N. R. 18W SEC 36. RM

[] Claimant acknowledges that portions of the following claim(s) site(s) may be void or voidable.

Printed Name of Claimant _____ Signature of Claimant _____

*****FINAL ADJUDICATION*****

DATE 7/27/2016 INITIALS [Signature]

LOCATION NOTICE FOR LODE MINING CLAIM

NOTICE IS HEREBY GIVEN that the C.O.D

lode mining claim has been located by

GRE INC whose current mailing

address is 2091 E Murray Holladay Road Suite 22E, SLC, UT 84117.

The general course of this claim is EAST TO WEST and it is

situated in MOHAVE County, Arizona. This claim is 1500 feet in length and 600 feet in width.

The C.O.D Lode Mining Claim is located pursuant to 43 C.F.R. 3832.12 (b), and described by metes and bounds, including a description of the tie to an official survey monument as follows: Beginning at Northwest corner #1, thence 1500 feet east at 90° to Northeast corner #2, thence 600 feet south at 180° to Southeast corner #3, thence 1500 feet west at 270°, to Southwest corner #4, thence 600 feet north at 0° back to Northwest corner #1, place of beginning.

Tie Point: Beginning at T 23N R 17W survey monument for corner of sections 26, 27, 34, 35 thence North 87° 17 minutes 30 seconds West a distance of 9,686 feet to claim corner #1.

The location monument on which this notice is posted is situated within Section 28, Township 23N, Range 17W, Gila Salt River Base and Meridian, Arizona and this claim encompasses portions

of the following quarter section (s), section (s), Township (s) and Range (s) SW ¼ OF SECTION 28 T23N R17W & NW ¼ OF SECTION 33 T23N R17W

Gila and Salt River Meridian, Arizona.

This Notice of Location has been written to capture mineral rights within its boundaries, only on open and locatable ground. In the case that some or parts of the claim boundaries overlap private or patented land it is understood that no rights or ownership is implied or assumed in relation to that portion of the claim. In the case that any part of this claim boundary may overlap another, pre-existing claim, it is understood that no rights or ownership is implied or assumed in relation to that portion of the claim. Any overlap or overstaking that has occurred is solely due to standard sizing of claims and there is no claim or ownership implied or assumed.

DATED AND POSTED on the ground this 24TH day of September, 2016.

LOCATOR (s) [Signature]
Crystal Sutton (agent for GRE Inc)

RECEIVED
BLM
AZ STATE OFFICE
2016 NOV 15 P 1:55
PHOENIX, ARIZONA

ANCI40223

MINING CLAIM MAP

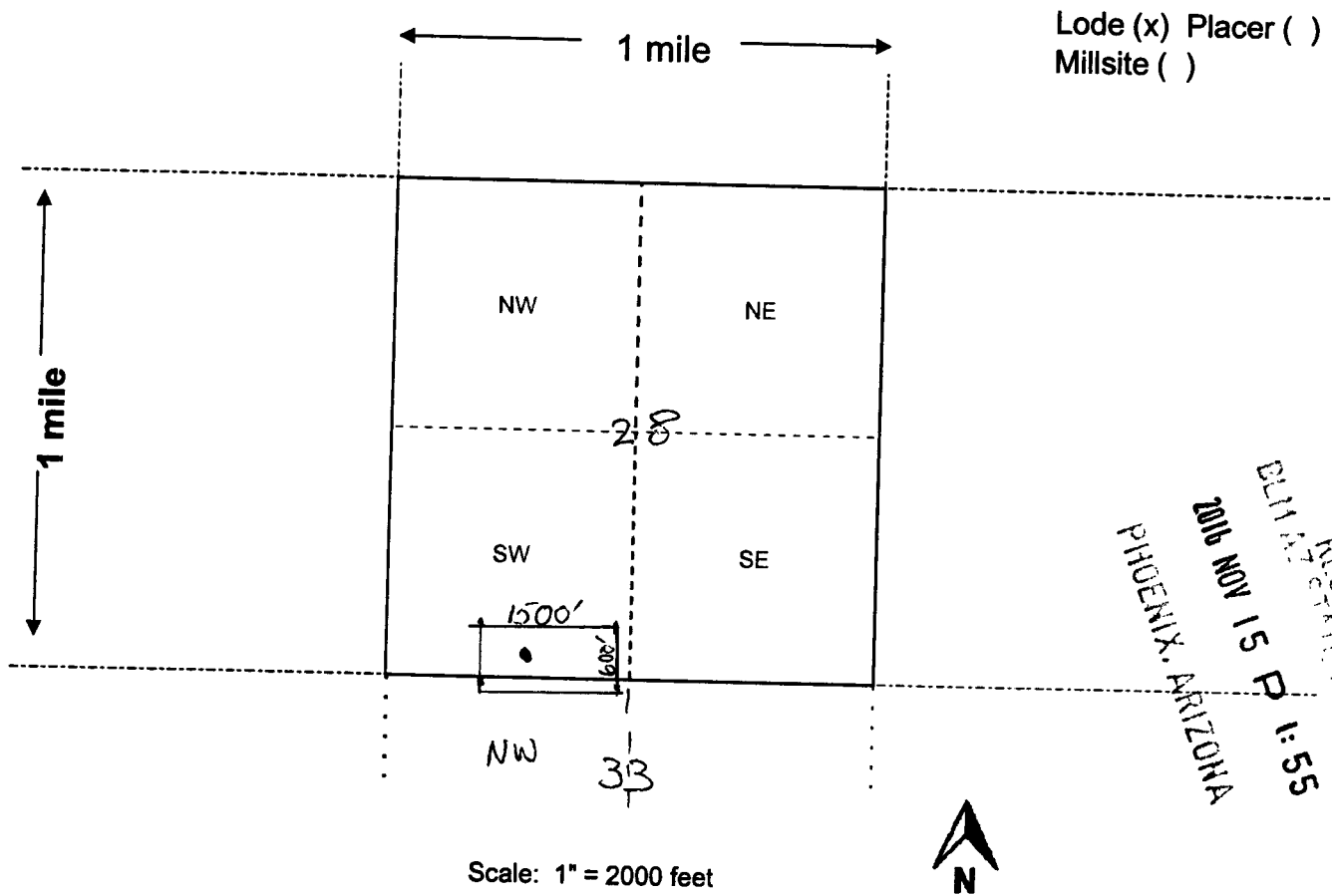

Lode (x) Placer ()
Millsite ()

RECEIVED OFFICE
DEPT. OF REVENUE
2009 NOV 15 P 1:55
PHOENIX, ARIZONA

1. The above map depicts the C.O.D. LODE mining claim, which is located in Section (s) 28 & 33, Township 23N , Range 17W , Gila and Salt River Base and Meridian, MOHAVE County, Arizona. Total claim acreage is 20.66
2. The type of corner and location monuments used are as follows: 2"X2" WOODEN STAKES
 WITH FLAGGING
3. The bearings and distances in degrees and feet between claim corners and to a public land survey monument are as depicted on the map.
4. If the claim is a placer or millsite claim with exterior limits conforming to legal subdivisions of the public survey, provide a legal description of the claim _____

AHC 4 10 223

LOCATION NOTICE FOR LODE MINING CLAIM

NOTICE IS HEREBY GIVEN that the DARDANELLES

lode mining claim has been located by

GRE INC whose current mailing

address is 2091 E Murray Holladay Road Suite 22E, SLC, UT 84117.

The general course of this claim is EAST TO WEST and it is

situated in MOHAVE County, Arizona. This claim is 1500 feet in length and 600 feet in width.

The Dardanelles Lode Mining Claim is located pursuant to 43 C.F.R. 3832.12 (b), and described by metes and bounds, including a description of the tie to an official survey monument as follows: Beginning at Northeast corner #1, thence 600 feet south at 180° to Southeast corner #2, thence 1500 feet west at 270° to Southwest corner #3, thence 600 feet North at 0°, to Northwest corner #4, thence 1500 feet East at 90° back to Northeast corner #1, place of beginning.

Tie Point: Beginning at T 24N R 17W survey monument for the SE corner of section 36 thence North 70° 5 minutes 45 seconds West a distance of 11,490 feet to claim corner #1.

The location monument on which this notice is posted is situated within Section 34, Township 24N, Range 18W, Gila Salt River Base and Meridian, Arizona and this claim encompasses portions

of the following quarter section (s), section (s), Township (s) and Range (s) NE ¼ OF SECTION 34 T24N R18W

Gila and Salt River Meridian, Arizona.

This Notice of Location has been written to capture mineral rights within its boundaries, only on open and locatable ground. In the case that some or parts of the claim boundaries overlap private or patented land it is understood that no rights or ownership is implied or assumed in relation to that portion of the claim. In the case that any part of this claim boundary may overlap another, pre-existing claim, it is understood that no rights or ownership is implied or assumed in relation to that portion of the claim. Any overlap or overstaking that has occurred is solely due to standard sizing of claims and there is no claim or ownership implied or assumed.

DATED AND POSTED on the ground this 1st day of September, 2016.

LOCATOR (s) 
Crystal Sutton (agent for GRE Inc)

BLM
Date
Stamp

RECEIVED
BLM 17 STATION OFFICE
2016 NOV 15 P 1:55
PHOENIX, ARIZONA

AHCH40224

MINING CLAIM MAP

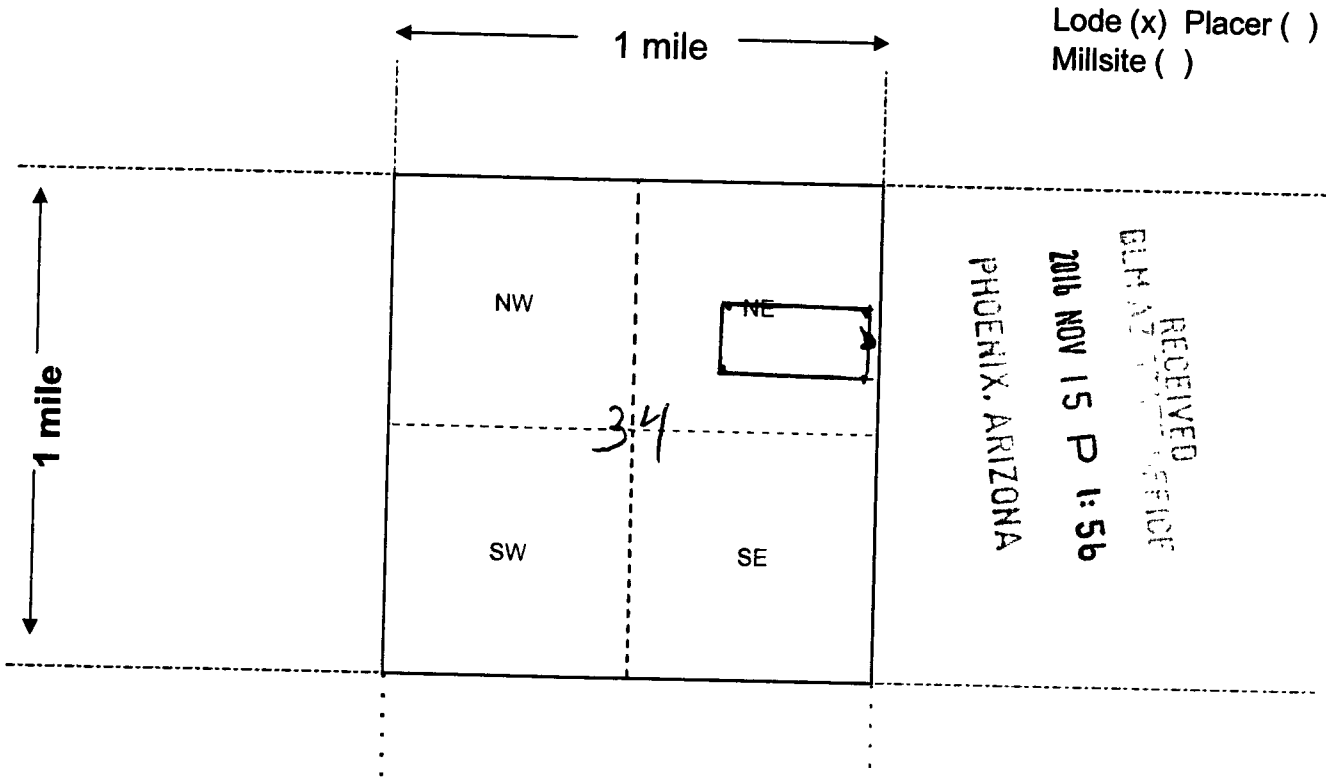

Scale: 1" = 2000 feet



A110440224

1. The above map depicts the Dardanelles mining claim, which is located in Section (s) 34, Township 24 N, Range 18 W, Gila and Salt River Base and Meridian, Mohave County, Arizona. Total claim acreage is 20.66
2. The type of corner and location monuments used are as follows: 2"X2" WOODEN STAKES WITH FLAGGING
3. The bearings and distances in degrees and feet between claim corners and to a public land survey monument are as depicted on the map.
4. If the claim is a placer or millsite claim with exterior limits conforming to legal subdivisions of the public survey, provide a legal description of the claim _____

Form MCF100a
Revised July 2014

This form is available from the Arizona Geology Survey and may be reproduced.

LOCATION NOTICE FOR LODE MINING CLAIM

NOTICE IS HEREBY GIVEN that the PEACOCK

lode mining claim has been located by

GRE INC whose current mailing

address is 2091 E Murray Holladay Road Suite 22E, SLC, UT 84117.

The general course of this claim is NORTHWEST TO SOUTHEAST

situated in MOHAVE County, Arizona. This claim is 1500 feet in length and 600 feet in width.

The PEACOCK Lode Mining Claim is located pursuant to 43 C.F.R. 3832.12 (b), and described by metes and bounds, including a description of the tie to an official survey monument as follows:

Beginning at North corner #1, thence 1500 feet southeast at 135° to East corner #2, thence 600 feet southwest at 225° to South corner #3, thence 1500 feet northwest at 315°, to West corner #4, thence 600 feet northeast at 45° back to North corner #1, place of beginning.

Tie Point: Beginning at T 23N R 14W survey monument for NW corner of sections 6, thence South 45° 42 minutes 3 seconds East a distance of 12,116 feet to claim corner #1.

The location monument on which this notice is posted is situated within Section 8, Township 23N, Range 14W, Gila Salt River Base and Meridian, Arizona and this claim encompasses portions

of the following quarter section (s), section (s), Township (s) and Range (s) SE ¼ OF SECTION 8 T23N R14W

Gila and Salt River Meridian, Arizona.

This Notice of Location has been written to capture mineral rights within its boundaries, only on open and locatable ground. In the case that some or parts of the claim boundaries overlap private or patented land it is understood that no rights or ownership is implied or assumed in relation to that portion of the claim. In the case that any part of this claim boundary may overlap another, pre-existing claim, it is understood that no rights or ownership is implied or assumed in relation to that portion of the claim. Any overlap or overstaking that has occurred is solely due to standard sizing of claims and there is no claim or ownership implied or assumed.

DATED AND POSTED on the ground this 24TH day of September, 2016.

LOCATOR (s) 
Crystal Sutton (agent for GRE Inc)

RECEIVED
BLM AT STATE OFFICE
2016 NOV 15 P 1:55
PHOENIX, ARIZONA

BLM
Date
Stamp

AHC440225

MINING CLAIM MAP

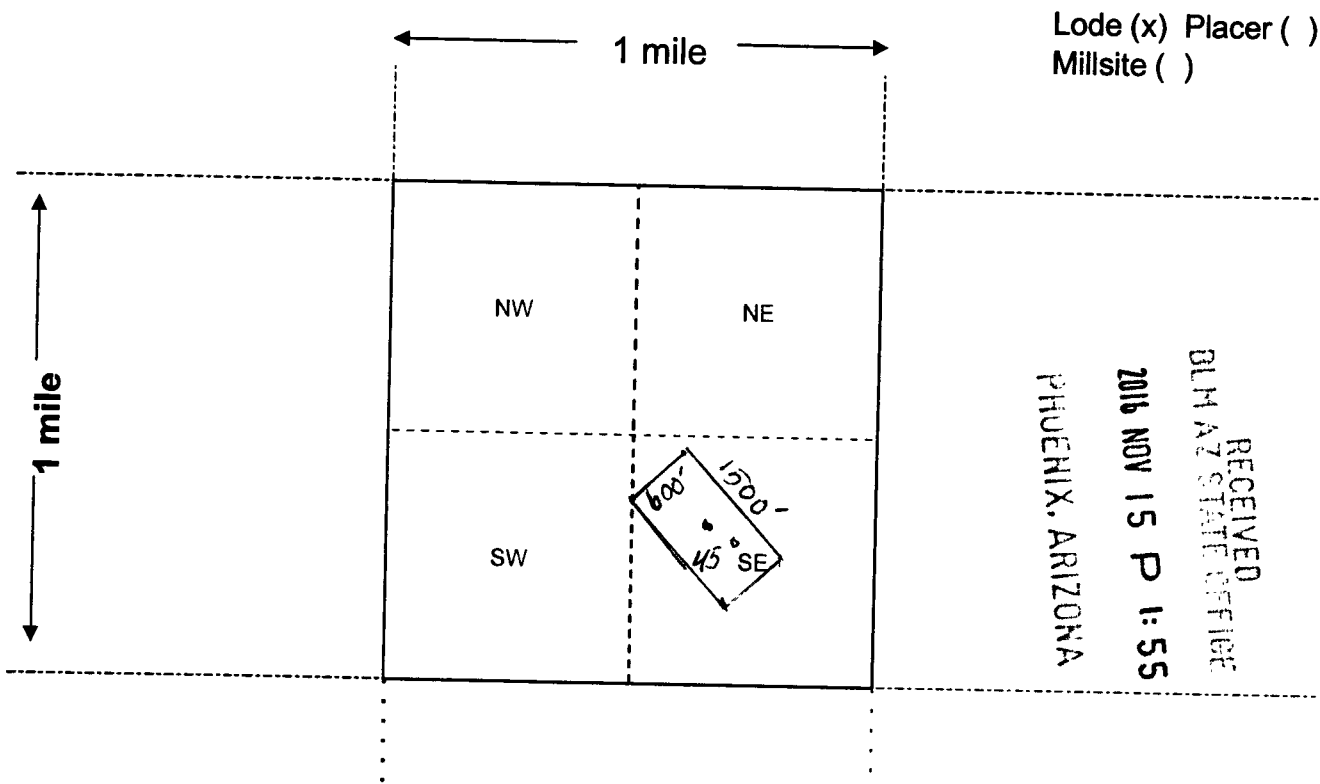

AHL44U7CJ

1. The above map depicts the PEACOCK LODE mining claim, which is located in Section (s) 8, Township 23N, Range 14W, Gila and Salt River Base and Meridian, MOHAVE County, Arizona. Total claim acreage is 20.66
2. The type of corner and location monuments used are as follows: 2"X2" WOODEN STAKES WITH FLAGGING
3. The bearings and distances in degrees and feet between claim corners and to a public land survey monument are as depicted on the map.
4. If the claim is a placer or millsite claim with exterior limits conforming to legal subdivisions of the public survey, provide a legal description of the claim _____

Form MCF100a
Revised July 2014

LOCATION NOTICE FOR LODE MINING CLAIM

NOTICE IS HEREBY GIVEN that the INAUGURATION

lode mining claim has been located by

GRE INC whose current mailing

address is 2091 E Murray Holladay Road Suite 22E, SLC, UT 84117.

The general course of this claim is NORTH TO SOUTH and it is

situated in MOHAVE County, Arizona. This claim is 1500 feet in length and 600 feet in width.

The INAUGURATION Lode Mining Claim is located pursuant to 43 C.F.R. 3832.12 (b), and described by metes and bounds, including a description of the tie to an official survey monument as follows: Beginning at Northeast corner #1, thence 1500 feet south at 180° to Southeast corner #2, thence 600 feet west at 270° to Southwest corner #3, thence 1500 feet North at 0°, to Northwest corner #4, thence 600 feet East at 90° back to Northeast corner #1, place of beginning.

Tie Point: Beginning at T 22N R 18W survey monument for corner of sections 13, 14, 23, 24 thence North 13° 5 minutes 54 seconds East a distance of 10,721 feet to claim corner #1.

The location monument on which this notice is posted is situated within Section 12, Township 22N, Range 18W, Gila Salt River Base and Meridian, Arizona and this claim encompasses portions

of the following quarter section (s), section (s), Township (s) and Range (s) NW ¼ OF SECTION 12 T22N R18W

Gila and Salt River Meridian, Arizona.

This Notice of Location has been written to capture mineral rights within its boundaries, only on open and locatable ground. In the case that some or parts of the claim boundaries overlap private or patented land it is understood that no rights or ownership is implied or assumed in relation to that portion of the claim. In the case that any part of this claim boundary may overlap another, pre-existing claim, it is understood that no rights or ownership is implied or assumed in relation to that portion of the claim. Any overlap or overstaking that has occurred is solely due to standard sizing of claims and there is no claim or ownership implied or assumed.

DATED AND POSTED on the ground this 24TH day of September, 2016.

LOCATOR (s) [Signature]
Crystal Sutton (agent for GRE Inc)

RECEIVED
BLM AT STATE OFFICE
2016 NOV 15 P 1:55
PHOENIX, ARIZONA
BLM
Date
Stamp

AR1044022b

MINING CLAIM MAP

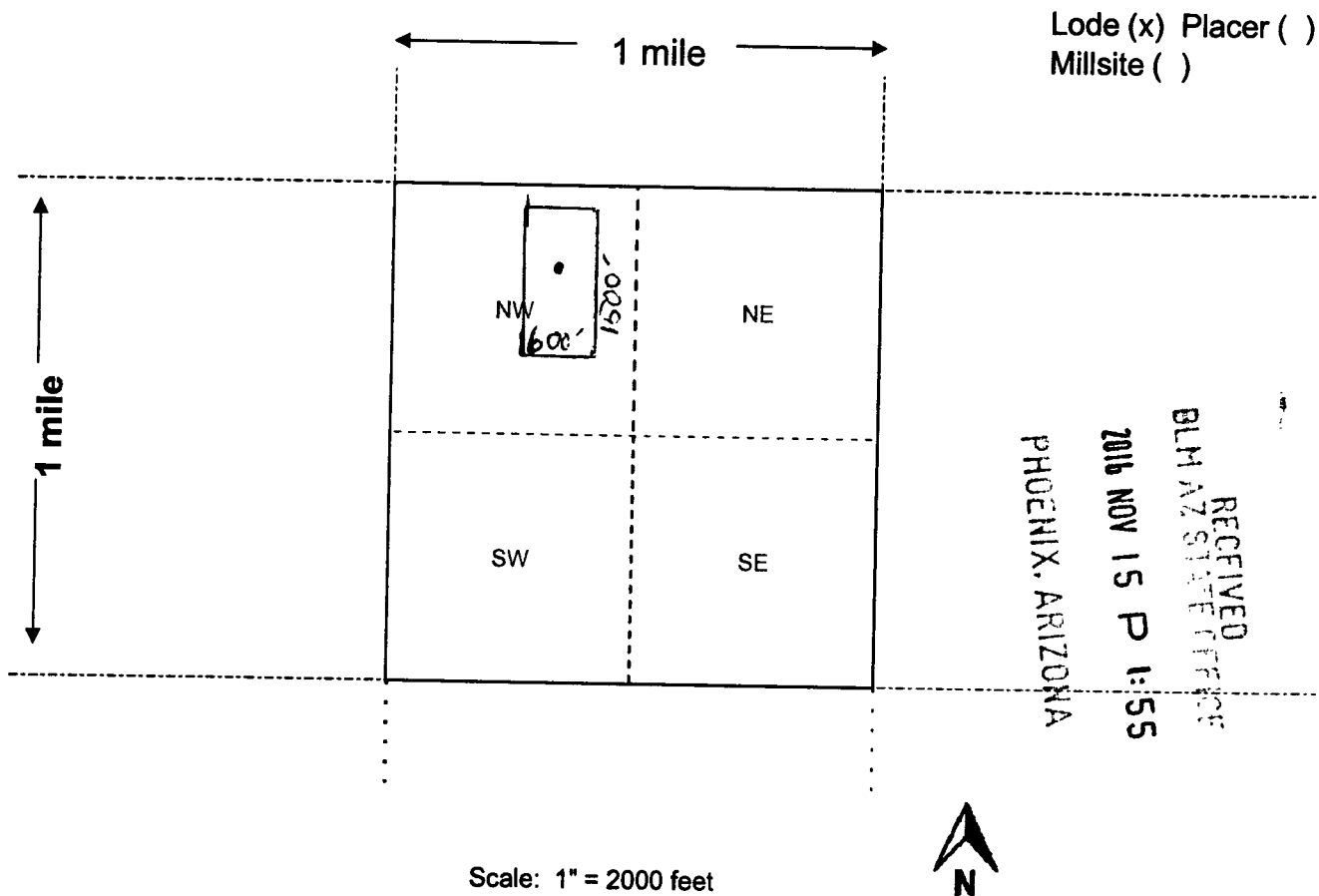

AHCH4022b

1. The above map depicts the INAUGURATION LODE mining claim, which is located in Section (s) 12, Township 22N, Range 18W, Gila and Salt River Base and Meridian, MOHAVE County, Arizona. Total claim acreage is 20.66
2. The type of corner and location monuments used are as follows: 2"X2" WOODEN STAKES WITH FLAGGING
3. The bearings and distances in degrees and feet between claim corners and to a public land survey monument are as depicted on the map.
4. If the claim is a placer or millsite claim with exterior limits conforming to legal subdivisions of the public survey, provide a legal description of the claim _____

Form MCF100a
Revised July 2014

LOCATION NOTICE FOR LODE MINING CLAIM

NOTICE IS HEREBY GIVEN that the ROSE

lode mining claim has been located by

GRE INC whose current mailing

address is 2091 E Murray Holladay Road Suite 22E, SLC, UT 84117.

The general course of this claim is NORTHWEST TO SOUTHEAST

situated in MOHAVE County, Arizona. This claim is 1500 feet in length and 600 feet in width.

The ROSE Lode Mining Claim is located pursuant to 43 C.F.R. 3832.12 (b), and described by metes and bounds, including a description of the tie to an official survey monument as follows: Beginning at North corner #1, thence 1500 feet Southeast at 135° to East corner #2, thence 600 feet Southwest at 225° to South corner #3, thence 1500 feet Northwest at 315°, to west corner #4, thence 600 feet Northeast at 45° back to North corner #1, place of beginning.

Tie Point: Beginning at T 19N R 20W survey monument for corner of sections 3, 4, 9, 10 thence South 57° 23 minutes 48 seconds East a distance of 2,358 feet to claim corner #1.

The location monument on which this notice is posted is situated within Section 10, Township 19N, Range 20W, Gila Salt River Base and Meridian, Arizona and this claim encompasses portions

of the following quarter section (s), section (s), Township (s) and Range (s) NE ¼, NW ¼, & SW ¼ OF SECTION 10 T19N R20W

Gila and Salt River Meridian, Arizona.

This Notice of Location has been written to capture mineral rights within its boundaries, only on open and locatable ground. In the case that some or parts of the claim boundaries overlap private or patented land it is understood that no rights or ownership is implied or assumed in relation to that portion of the claim. In the case that any part of this claim boundary may overlap another, pre-existing claim, it is understood that no rights or ownership is implied or assumed in relation to that portion of the claim. Any overlap or overstaking that has occurred is solely due to standard sizing of claims and there is no claim or ownership implied or assumed.

DATED AND POSTED on the ground this 24th day of September, 2016.

LOCATOR (s) 
Crystal Sutton (agent for GRE Inc)

RECEIVED
BLM AZ STATE OFFICE
2016 NOV 15 P 1:55
PHOENIX, ARIZONA
BLM
Date
Stamp

AHCH40227

MINING CLAIM MAP

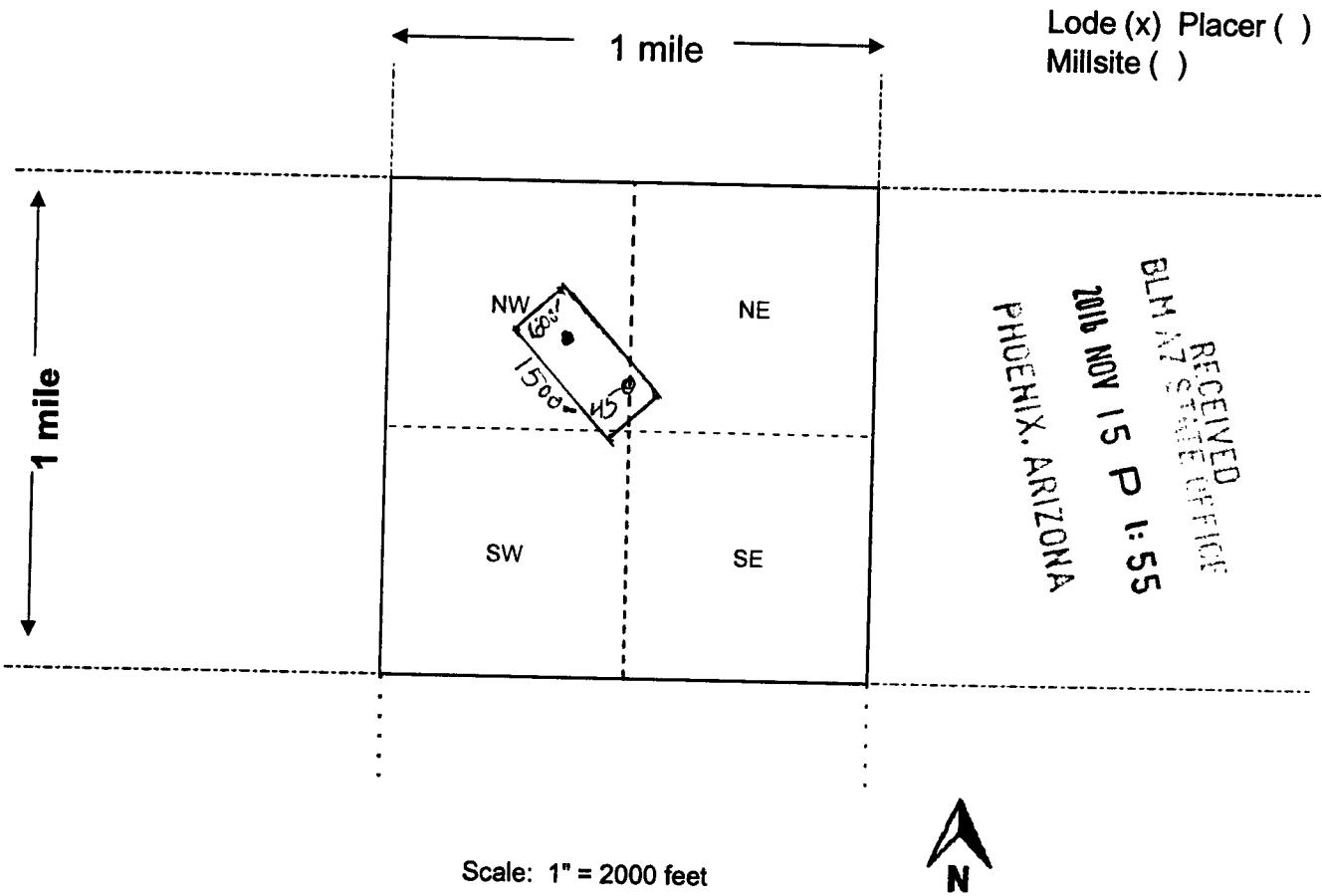

Lode (x) Placer ()
Millsite ()

RECEIVED
BLM AZ STATE OFFICE
2016 NOV 15 P 1:55
PHOENIX, ARIZONA

AHC440221

1. The above map depicts the ROSE LODGE mining claim, which is located in Section (s) 10, Township 19N, Range 20W, Gila and Salt River Base and Meridian, MOHAVE County, Arizona. Total claim acreage is 20.66
2. The type of corner and location monuments used are as follows: 2"X2" WOODEN STAKES WITH FLAGGING
3. The bearings and distances in degrees and feet between claim corners and to a public land survey monument are as depicted on the map.
4. If the claim is a placer or millsite claim with exterior limits conforming to legal subdivisions of the public survey, provide a legal description of the claim _____

Form MCF100a
Revised July 2014

LOCATION NOTICE FOR LODE MINING CLAIM

NOTICE IS HEREBY GIVEN that the SOUTH PILGRIM

lode mining claim has been located by

GRE INC whose current mailing

address is 2091 E Murray Holladay Road Suite 22E, SLC, UT 84117.

The general course of this claim is NORTH TO SOUTH and it is

situated in MOHAVE County, Arizona. This claim is 1500 feet in length and 600 feet in width.

The SOUTH PILGRIM Lode Mining Claim is located pursuant to 43 C.F.R. 3832.12 (b), and described by metes and bounds, including a description of the tie to an official survey monument as follows: Beginning at Northeast corner #1, thence 1500 feet south at 180° to Southeast corner #2, thence 600 feet west at 270° to Southwest corner #3, thence 1500 feet north at 0°, to Northwest corner #4, thence 600 feet east at 90° back to Northeast corner #1, place of beginning.

Tie Point: Beginning at T 23N R 19W survey monument for corner of sections 7, 8, 17, 18 thence South 71° 8 minutes 21 seconds West a distance of 6,243 feet to claim corner #1.

The location monument on which this notice is posted is situated within Section 13, Township 23N, Range 20W, Gila Salt River Base and Meridian, Arizona and this claim encompasses portions

of the following quarter section (s), section (s), Township (s) and Range (s) NE ¼ & SE ¼ OF SECTION 13 T23N R20W

Gila and Salt River Meridian, Arizona.

This Notice of Location has been written to capture mineral rights within its boundaries, only on open and locatable ground. In the case that some or parts of the claim boundaries overlap private or patented land it is understood that no rights or ownership is implied or assumed in relation to that portion of the claim. In the case that any part of this claim boundary may overlap another, pre-existing claim, it is understood that no rights or ownership is implied or assumed in relation to that portion of the claim. Any overlap or overstaking that has occurred is solely due to standard sizing of claims and there is no claim or ownership implied or assumed.

DATED AND POSTED on the ground this 24TH day of SEPTEMBER, 2016.

LOCATOR (s) [Signature]
Crystal Sutton (agent for GRE Inc)

RECEIVED
BLM AT STAFF
2016 NOV 15 P 1:55
PHOENIX, ARIZONA
BLM
Date
Stamp

AHC440228

MINING CLAIM MAP

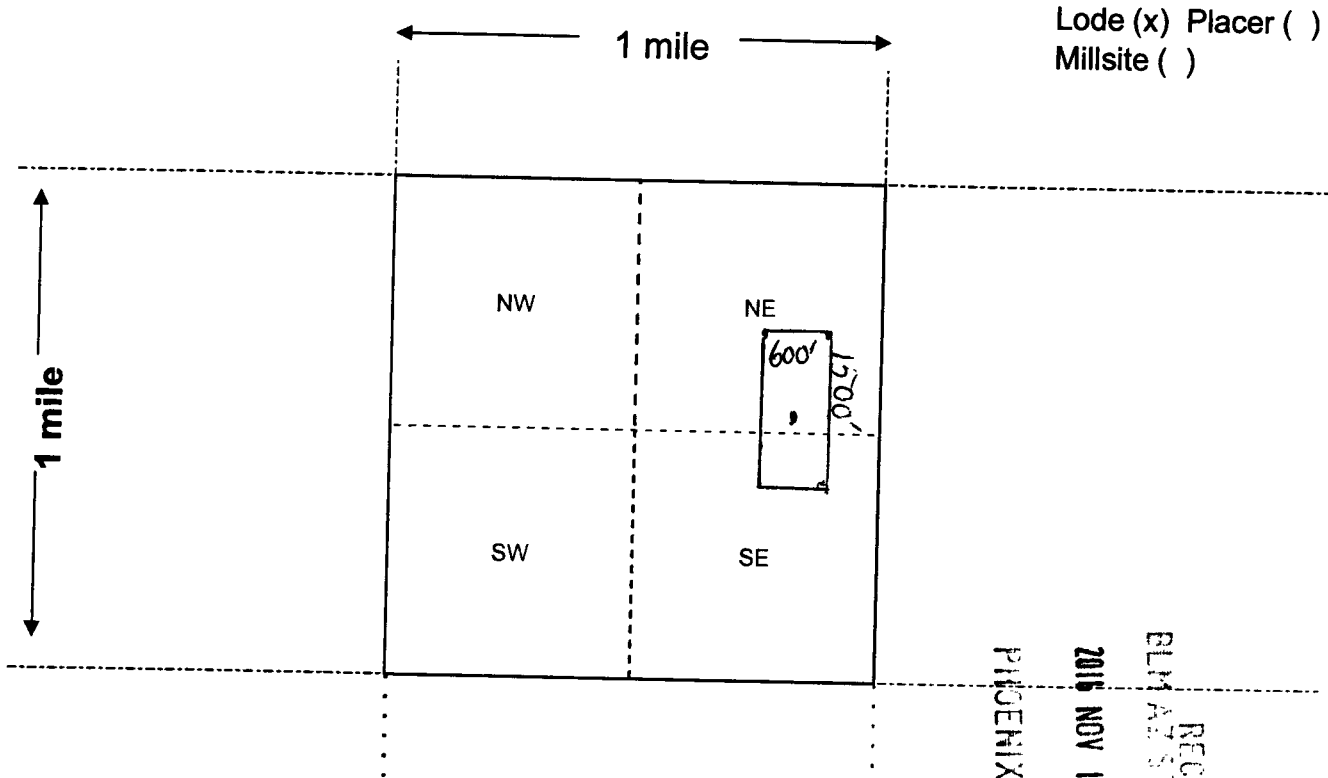

RECEIVED
BLM AT STATE OFFICE
2016 NOV 15 P 1:55
PISCENIX, ARIZONA

AHC440228

Scale: 1" = 2000 feet

1. The above map depicts the SOUTH PILGRIM LODE mining claim, which is located in Section 13 Township 23N, Range 20W, Gila and Salt River Base and Meridian, MOHAVE County, Arizona. Total claim acreage is 20.66
2. The type of corner and location monuments used are as follows: 2"X2" WOODEN STAKES WITH FLAGGING
3. The bearings and distances in degrees and feet between claim corners and to a public land survey monument are as depicted on the map.
4. If the claim is a placer or millsite claim with exterior limits conforming to legal subdivisions of the public survey, provide a legal description of the claim _____

Form MCF100a
Revised July 2014

This form is available from the **Arizona Geology Survey** and may be reproduced.

Input Parameters for Geographic Report with Land

System Id = CR

Admin State = AZ

Geo State =

Casetype Begins With

Case Disp Txt = AUTHORIZED, CANCELLED, EXPIRED, PENDING, REJECTED, RELINQUISHED, WITHDRAWN

Mer Twp Rng =

Section =

Mtrs = 14 0190N 0200W 010, 14 0190N 0200W 999, 14 0220N 0180W 012, 14 0220N 0180W 999, 14 0230N 0140W 008, 14 0230N 0140W 999, 14 0230N 0170W 028, 14 0230N 0170W 033, 14 0230N 0170W 999, 14 0230N 0200W 013, 14 0230N 0200W 999, 14 0240N 0180W 034, 14 0240N 0180W 999

Commodity =

Commodity Txt =

Pending Org =

Pend Org Decode =

Total Rows Returned: 33

RUN TIME: 10:22 AM

UNITED STATES DEPARTMENT OF INTERIOR
BUREAU OF LAND MANAGEMENT
GEOGRAPHIC REPORT WITH LAND
Sorted by Serial Number

RUN DATE: 11/22/2016

Page 1 of 5

Adm State: AZ

Serial Number: AZA 003272

Total Case Acres: 3.900

<u>Casetype</u>	<u>Case Disp</u>				<u>Sect</u>	<u>Sur Typ</u>	<u>Sur Num</u>	<u>Suff</u>	<u>Subdivision</u>	<u>Act Pend</u>
287300	AUTHORIZED	14	0240N	0180W	034	ALIQ LOTS			NESW; 5;	

Serial Number: AZA 004423

Total Case Acres: 1.830

<u>Casetype</u>	<u>Case Disp</u>				<u>Sect</u>	<u>Sur Typ</u>	<u>Sur Num</u>	<u>Suff</u>	<u>Subdivision</u>	<u>Act Pend</u>
.288100	AUTHORIZED	14	0190N	0200W	010	ALIQ			SESW;	

Serial Number: AZA 004549

Total Case Acres: 0.460

<u>Casetype</u>	<u>Case Disp</u>				<u>Sect</u>	<u>Sur Typ</u>	<u>Sur Num</u>	<u>Suff</u>	<u>Subdivision</u>	<u>Act Pend</u>
285002	AUTHORIZED	14	0190N	0200W	010	MNR MNR		1 2	SENESEW,NESESEW,SWNWSE; NWSWSE;	

Serial Number: AZA 005483

Total Case Acres: 0.960

<u>Casetype</u>	<u>Case Disp</u>				<u>Sect</u>	<u>Sur Typ</u>	<u>Sur Num</u>	<u>Suff</u>	<u>Subdivision</u>	<u>Act Pend</u>
285002	AUTHORIZED	14	0240N	0180W	034	ALIQ LOTS			NESW; 5;	

Serial Number: AZA 005877

Total Case Acres: 39.250

<u>Casetype</u>	<u>Case Disp</u>				<u>Sect</u>	<u>Sur Typ</u>	<u>Sur Num</u>	<u>Suff</u>	<u>Subdivision</u>	<u>Act Pend</u>
286203	AUTHORIZED	14	0220N	0180W	012	ALIQ LOTS			SESW; 5,6;	

RUN TIME: 10:22 AM

UNITED STATES DEPARTMENT OF INTERIOR
BUREAU OF LAND MANAGEMENT
GEOGRAPHIC REPORT WITH LAND
Sorted by Serial Number

RUN DATE: 11/22/2016

Page 2 of 5

Adm State: AZ

Serial Number: AZA 007735

Total Case Acres: 1.070

<u>Casetype</u>	<u>Case Disp</u>	14	0240N	0180W	<u>Sect</u>	<u>Sur Typ</u>	<u>Sur Num</u>	<u>Suff</u>	<u>Subdivision</u>	<u>Act Pend</u>
287300	AUTHORIZED				034	ALIQ			NESW,NENWSW;	

Serial Number: AZA 008051

Total Case Acres: 0.454

<u>Casetype</u>	<u>Case Disp</u>	14	0240N	0180W	<u>Sect</u>	<u>Sur Typ</u>	<u>Sur Num</u>	<u>Suff</u>	<u>Subdivision</u>	<u>Act Pend</u>
285002	AUTHORIZED				034	MNR		1	N2N2SW;	

Serial Number: AZA 014911

Total Case Acres: 64.680

<u>Casetype</u>	<u>Case Disp</u>	14	0190N	0200W	<u>Sect</u>	<u>Sur Typ</u>	<u>Sur Num</u>	<u>Suff</u>	<u>Subdivision</u>	<u>Act Pend</u>
285003	AUTHORIZED				010	ALIQ FF			SEW; NE & SW EXCEPT PAT MC;	

Serial Number: AZA 020912

Total Case Acres: 78.880

<u>Casetype</u>	<u>Case Disp</u>	14	0190N	0200W	<u>Sect</u>	<u>Sur Typ</u>	<u>Sur Num</u>	<u>Suff</u>	<u>Subdivision</u>	<u>Act Pend</u>
281001	AUTHORIZED				010	ALIQ			W2,SWSE;	

Serial Number: AZA 021021

Total Case Acres: 283.250

<u>Casetype</u>	<u>Case Disp</u>	14	0190N	0200W	<u>Sect</u>	<u>Sur Typ</u>	<u>Sur Num</u>	<u>Suff</u>	<u>Subdivision</u>	<u>Act Pend</u>
281001	AUTHORIZED				010	FF LOTS		1	E2SWSE EXCEPT MS 3408; 4;	

RUN TIME: 10:22 AM

UNITED STATES DEPARTMENT OF INTERIOR
BUREAU OF LAND MANAGEMENT
GEOGRAPHIC REPORT WITH LAND
Sorted by Serial Number

RUN DATE: 11/22/2016

Page 3 of 5

Adm State: AZ

Serial Number: AZA 024819

Total Case Acres: 87.900

<u>Casetype</u>	<u>Case Disp</u>	14	0190N	0200W	<u>Sect</u>	<u>Sur Typ</u>	<u>Sur Num</u>	<u>Suff</u>	<u>Subdivision</u>	<u>Act Pend</u>
288100	AUTHORIZED				010	FF		1	LOT 4,EXCEPT PAT.;	

Serial Number: AZA 028810

Total Case Acres: 0.760

<u>Casetype</u>	<u>Case Disp</u>	14	0190N	0200W	<u>Sect</u>	<u>Sur Typ</u>	<u>Sur Num</u>	<u>Suff</u>	<u>Subdivision</u>	<u>Act Pend</u>
285002	AUTHORIZED				010	ALIQ			SWSE;	

Serial Number: AZA 028811

Total Case Acres: 0.940

<u>Casetype</u>	<u>Case Disp</u>	14	0190N	0200W	<u>Sect</u>	<u>Sur Typ</u>	<u>Sur Num</u>	<u>Suff</u>	<u>Subdivision</u>	<u>Act Pend</u>
286203	AUTHORIZED				010	ALIQ			SWSE;	

Serial Number: AZA 029181

Total Case Acres: 3.900

<u>Casetype</u>	<u>Case Disp</u>	14	0230N	0170W	<u>Sect</u>	<u>Sur Typ</u>	<u>Sur Num</u>	<u>Suff</u>	<u>Subdivision</u>	<u>Act Pend</u>
380913	EXPIRED				028	MNR		1	SESESE;	

Serial Number: AZA 030409

Total Case Acres: 1.200

<u>Casetype</u>	<u>Case Disp</u>	14	0190N	0200W	<u>Sect</u>	<u>Sur Typ</u>	<u>Sur Num</u>	<u>Suff</u>	<u>Subdivision</u>	<u>Act Pend</u>
287001	AUTHORIZED				010	LOTS MNR			4; W2SWSE;	

RUN TIME: 10:22 AM

UNITED STATES DEPARTMENT OF INTERIOR
BUREAU OF LAND MANAGEMENT
GEOGRAPHIC REPORT WITH LAND
Sorted by Serial Number

RUN DATE: 11/22/2016

Page 4 of 5

Adm State: AZ

Serial Number: AZA 033610

Total Case Acres: 1.090

<u>Casetype</u>	<u>Case Disp</u>	14	0240N	0180W	<u>Sect</u>	<u>Sur Typ</u>	<u>Sur Num</u>	<u>Suff</u>	<u>Subdivision</u>	<u>Act Pend</u>
287001	AUTHORIZED				034	FF			N2SW EXC. POR. IN MS3449;	

Serial Number: AZA 034457

Total Case Acres: 0.530

<u>Casetype</u>	<u>Case Disp</u>	14	0190N	0200W	<u>Sect</u>	<u>Sur Typ</u>	<u>Sur Num</u>	<u>Suff</u>	<u>Subdivision</u>	<u>Act Pend</u>
285003	AUTHORIZED				010	ALIQ			E2SW;	

Serial Number: AZA 035831

Total Case Acres: 30.000

<u>Casetype</u>	<u>Case Disp</u>	14	0240N	0180W	<u>Sect</u>	<u>Sur Typ</u>	<u>Sur Num</u>	<u>Suff</u>	<u>Subdivision</u>	<u>Act Pend</u>
361113	AUTHORIZED				034	ALIQ			W2;	

Serial Number: AZA 036388

Total Case Acres: 1.000

<u>Casetype</u>	<u>Case Disp</u>	14	0230N	0170W	<u>Sect</u>	<u>Sur Typ</u>	<u>Sur Num</u>	<u>Suff</u>	<u>Subdivision</u>	<u>Act Pend</u>
371511	PENDING				028	ALIQ			S2;	

Serial Number: AZAR 0017080

Total Case Acres: 148.037

<u>Casetype</u>	<u>Case Disp</u>	14	0190N	0200W	<u>Sect</u>	<u>Sur Typ</u>	<u>Sur Num</u>	<u>Suff</u>	<u>Subdivision</u>	<u>Act Pend</u>
288100	AUTHORIZED				010	FF		1	SESW,W2SE, LOT 3 LESS;	
						FF		2	PATENTED MINING CLAIMS;	

RUN TIME: 10:23 AM

UNITED STATES DEPARTMENT OF INTERIOR
BUREAU OF LAND MANAGEMENT
GEOGRAPHIC REPORT WITH LAND
Sorted by Serial Number

RUN DATE: 11/22/2016
Page 5 of 5

Adm State: AZ

Serial Number: AZAR 0023662
Total Case Acres: 164.600

<u>Casetype</u>	<u>Case Disp</u>	14	0190N	0200W	<u>Sect</u>	<u>Sur Typ</u>	<u>Sur Num</u>	<u>Suff</u>	<u>Subdivision</u>	<u>Act Pend</u>
288100	AUTHORIZED				010	ALIQ LOTS			NWSE,NESW,S2SW; 4;	

Serial Number: AZAR 0033343
Total Case Acres: 30.090

<u>Casetype</u>	<u>Case Disp</u>	14	0230N	0170W	<u>Sect</u>	<u>Sur Typ</u>	<u>Sur Num</u>	<u>Suff</u>	<u>Subdivision</u>	<u>Act Pend</u>
288100	AUTHORIZED				028	ALIQ			E2NE;	

Serial Number: AZPHX 0034352
Total Case Acres: 424.177

<u>Casetype</u>	<u>Case Disp</u>	14	0230N	0200W	<u>Sect</u>	<u>Sur Typ</u>	<u>Sur Num</u>	<u>Suff</u>	<u>Subdivision</u>	<u>Act Pend</u>
285003	AUTHORIZED				013	ALIQ			NE,NENW;	

Serial Number: AZPHX 0034352
Total Case Acres: 424.177

<u>Casetype</u>	<u>Case Disp</u>	14	0240N	0180W	<u>Sect</u>	<u>Sur Typ</u>	<u>Sur Num</u>	<u>Suff</u>	<u>Subdivision</u>	<u>Act Pend</u>
285003	AUTHORIZED				034	LOTS			1,3;	

CERTIFIED MAIL



7015 0640 0003 5824 1240



\$4.87⁰⁰ US POSTAGE
FIRST CLASS
06290305158
FROM 84117
LATVRS

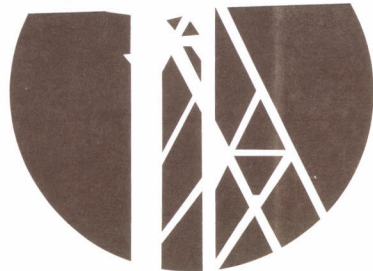

GOLD RUSH
EXPEDITIONS
2091 E. MURRAY HOLLADAY RD, STE. 22E
SALT LAKE CITY, UTAH 84117

Arizona BLM
Attn: Cashier
One N. Central Ave., Ste. 800
Phoenix, AZ 85004

RECEIVED
BLM AZ STATE OFFICE
2014 NOV 5 PM
PHOENIX, ARIZO